

NOTES:

1. MATERIAL OF CONSTRUCTION IS MILD STEEL COATED IN 2-4 MILS GREEN POWDER COATING WITH A ZINC ENRICHED PRIMER.
2. MATERIAL OF CONSTRUCTION IS ALUMINUM COATED IN 2-4 MILS WHITE POWDER COATING.

www.GooseneckStands.com
 (800) 878-7829
 Sales@GooseneckStands.com

UNLESS OTHERWISE SPECIFIED:
 DIMENSIONS ARE IN INCHES
 TOLERANCES:
 FRACTIONAL $\pm 1/32$
 ANGULAR: $\pm 2^\circ$
 TWO PLACE DECIMAL ± 0.010
 THREE PLACE DECIMAL ± 0.005
 INTERPRET GEOMETRIC
 TOLERANCING PER:
 ASME Y14.5 -2009

NAME	DATE
DRAWN	
CHECKED	

TITLE: INSTALLATION		SIZE A	PART NO.	REV A
WEIGHT: 75.581		NO SCALE		SHEET 1 OF 10

ITEM NO.	PART NUMBER	DESCRIPTION	QTY.
1	156TOW-EVCS-01-CRS BODY	CHARGE STATION MAIN BODY	1
2	156TOW-EVCS-01-CRS PANEL	CHARGE STATION PANEL	1
3	156TOW-EVCS-01-CRS BASE	CHARGE STATION BASE PLATE	2
4	156TOW-EVCS-01-CRS FACADE	CHARGE STATION ALUMINUM FACADE	2
5	156TOW-EVCS-01-CRS BRACE	INTERNAL BRACING PLATE	2
6	156TOW-EVCS-01-CRS BLANK	CHARGE STATION BLANK CAP PLATE	1
7	--	1/4-20 X 1.25 STANDOFF ZNC PLT STL	12
8	--	1/4-20 X .5 SS FLT HD SCREW	12
9	--	1/2-13 X .75 SS FLT HD SCREW	8
10	--	1/4-20 STAINLESS STEEL PRESS-FIT NUT	12
11	--	1/4-20 X .75 SS PRESS-FIT STUDS	4
12	--	1/4-20 STAINLESS STEEL HEX NUT	4
13	--	1/4 STAINLESS STEEL WASHER	4
14	156TOW-EVCS-02-CRS DECAL	CHARGING STATION DECAL	2

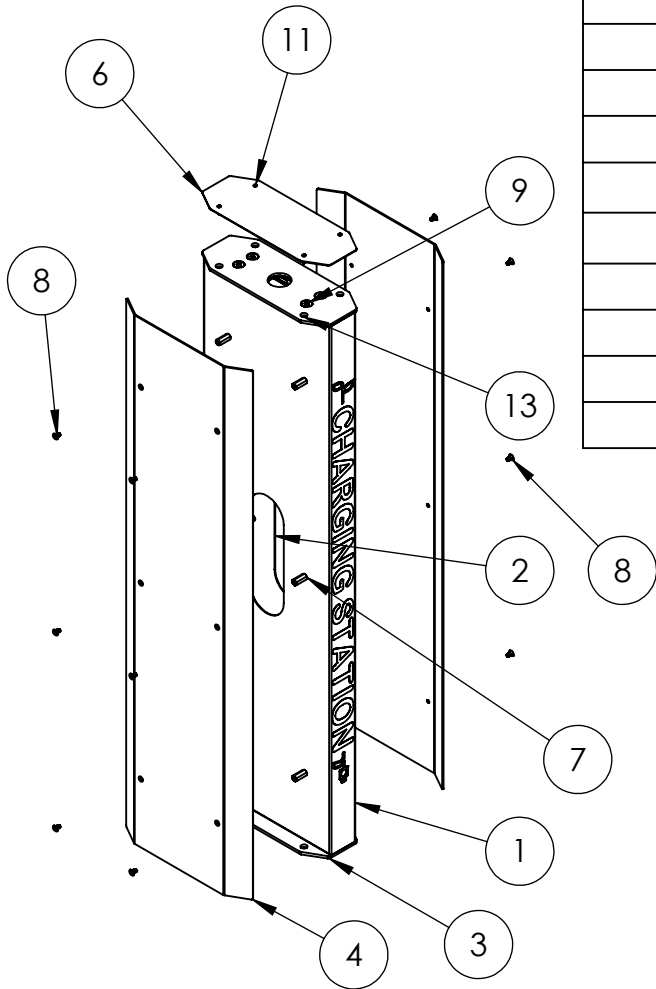

NOTES:

1. SEE STANDARD PREPARATION AND COATING INSTRUCTIONS FOR COATING PROCEDURE AND COLOR.
2. SEE STANDARD PACKAGING INSTRUCTIONS FOR PACKAGING PROCEDURE.

www.GooseneckStands.com
(800) 878-7829
Sales@GooseneckStands.com

UNLESS OTHERWISE SPECIFIED:
DIMENSIONS ARE IN INCHES
TOLERANCES:
FRACTIONAL $\pm 1/32$
ANGULAR: $\pm 2^\circ$
TWO PLACE DECIMAL ± 0.010
THREE PLACE DECIMAL ± 0.005
INTERPRET GEOMETRIC
TOLERANCING PER:
ASME Y14.5 -2009

NAME	DATE
DRAWN	
CHECKED	

TITLE: ASSEMBLY		SIZE A	PART NO.	REV A
WEIGHT: 75.581		NO SCALE		SHEET 2 OF 10