

- NOTES:
1. MATERIAL OF CONSTRUCTION IS 304 SS BRUSHED #4
 2. HID 5365 CUTOUT.

UNLESS OTHERWISE SPECIFIED: DIMENSIONS ARE IN INCHES TOLERANCES: FRACTIONAL: ±1/32 ANGULAR: ±2° TWO PLACE DECIMAL ±0.010 THREE PLACE DECIMAL ±0.005	NAME	DATE	TITLE: INSTALLATION	SIZE A	PART NO. 69HOU-HID-01-304	REV A
	DRAWN					
INTERPRET GEOMETRIC TOLERANCING PER: ASME Y14.5 -2009	CHECKED					

ITEM NO.	PART NUMBER	DESCRIPTION	QTY.
1	69HOU-HID-01-304 ENCLOSURE	ENCLOSURE WELDMENT	1
2	69HOU-HID-01-304 HOOD	HOOD	1
3	69HOU-HID-01-304 DOOR	DOOR WELDMENT	1
4	HINGE	PIANO HINGE	1
5	CAM LOCK	STRAIGHT CAM	1
6	GASKET SIDE	3/8" X .150 WEATHERSTRIPPING	2
7	GASKET TOP	3/8" X .150 WEATHERSTRIPPING	1
8	--	6-32 PAN HEAD SCREW	2
9	--	6-32 EXTERNAL TOOTH LOCK NUT	2

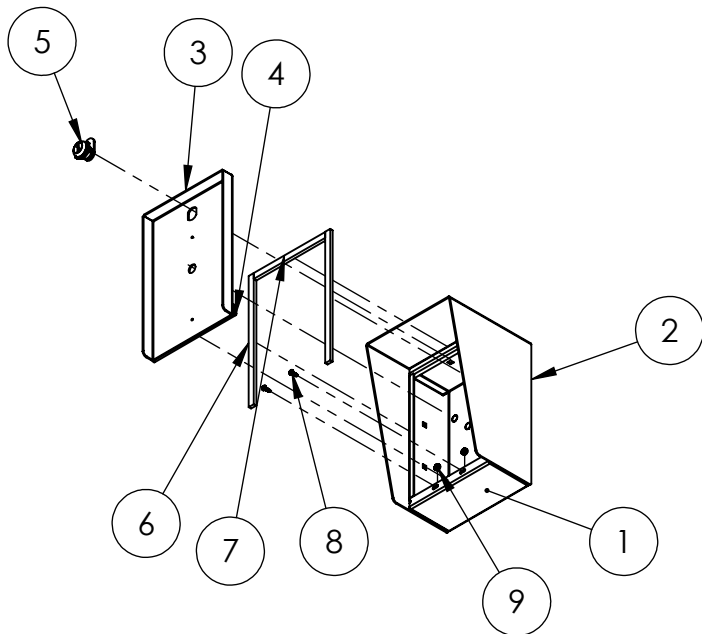

NOTES:

1. SEE STANDARD PREPARATION AND COATING INSTRUCTIONS FOR COATING PROCEDURE AND COLOR.
2. SEE STANDARD PACKAGING INSTRUCTIONS FOR PACKAGING PROCEDURE.

UNLESS OTHERWISE SPECIFIED:

DIMENSIONS ARE IN INCHES
TOLERANCES:
FRACTIONAL $\pm 1/32$
ANGULAR: $\pm 2^\circ$
TWO PLACE DECIMAL ± 0.010
THREE PLACE DECIMAL ± 0.005

INTERPRET GEOMETRIC
TOLERANCING PER:
ASME Y14.5 -2009

	NAME	DATE
DRAWN		
CHECKED		

TITLE:
ASSEMBLY

WEIGHT: 7.460	SIZE A	PART NO. 69HOU-HID-01-304	REV A
	NO SCALE	SHEET 2 OF 6	