

NOTES:

1. MATERIAL OF CONSTRUCTION IS 304 SS, BRUSHED #4.

<div>www.GooseneckStands.com</div> <div>(888) 378 - 1045</div> <div>Sales@GooseneckStands.com</div>	UNLESS OTHERWISE SPECIFIED:		NAME	DATE	TITLE:					
	DIMENSIONS ARE IN INCHES TOLERANCES: FRACTIONAL ±1/32 ANGULAR: ±2° TWO PLACE DECIMAL ±0.010 THREE PLACE DECIMAL ±0.005	DRAWN	PE		INSTALLATION					
		CHECKED								
		PROPRIETARY AND CONFIDENTIAL								
		THE INFORMATION CONTAINED IN THIS DRAWING IS THE SOLE PROPERTY OF PEDESTALPRO LLC. ANY REPRODUCTION IN PART OR AS A WHOLE WITHOUT THE WRITTEN PERMISSION OF PEDESTALPRO LLC IS PROHIBITED.				WEDNESDAY, JUNE 4, 2025 3:57:10 PM		SIZE A	PART NO. 84CAB-DOOR-01-304	REV A
	INTERPRET GEOMETRIC TOLERANCING PER: ASME Y14.5 -2009				WEIGHT: 51.420		NO SCALE		SHEET 1 OF 10	

ITEM NO.	PART NUMBER	DESCRIPTION	QTY.
1	84CAB-DOOR-01-304 MAIN BODY	MAIN BODY	1
2	84CAB-DOOR-01-304 TOP	TOP	1
3	84CAB-DOOR-01-304 ACCESS PANEL	ACCESS PANEL	1
4	84CAB-DOOR-01-304 BACK CLOSURE	BACK CLOSURE	1
5	84CAB-DOOR-01-304 BASE PLATE	BASE PLATE	1
6	12GA STIFFENER	STIFFENER	1
7	PLABRA-DB-D2102KV	BRACKET	1
8	--	8-32 X 1/2" PAN HEAD SCREW	10

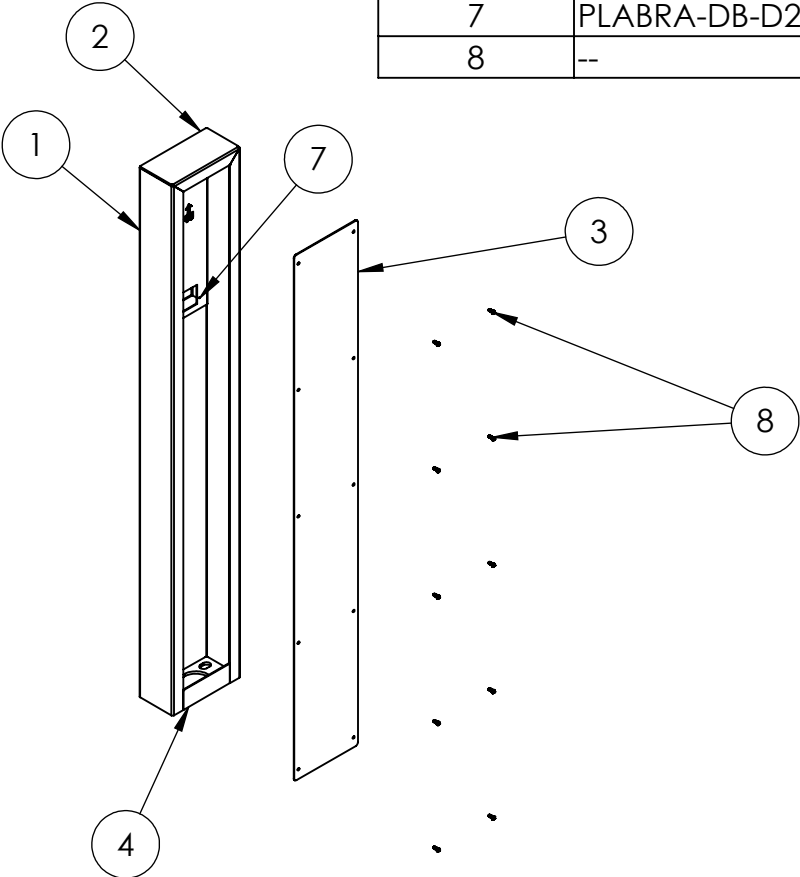

NOTES:

- SEE STANDARD PREPARATION AND COATING INSTRUCTIONS FOR COATING PROCEDURE AND COLOR.
- SEE STANDARD PACKAGING INSTRUCTIONS FOR PACKAGING PROCEDURE.

www.GooseneckStands.com (888) 378 - 1045 Sales@GooseneckStands.com	UNLESS OTHERWISE SPECIFIED:		NAME	DATE	TITLE: ASSEMBLY				
	DIMENSIONS ARE IN INCHES	DRAWN							
	TOLERANCES:	CHECKED							
	FRACTIONAL ±1/32	PROPRIETARY AND CONFIDENTIAL THE INFORMATION CONTAINED IN THIS DRAWING IS THE SOLE PROPERTY OF PEDESTALPRO LLC. ANY REPRODUCTION IN PART OR AS A WHOLE WITHOUT THE WRITTEN PERMISSION OF PEDESTALPRO LLC IS PROHIBITED.			WEDNESDAY, JUNE 4, 2025 3:57:10 PM	SIZE A	PART NO. 84CAB-DOOR-01-304	REV A	
	ANGULAR: ±2°								
TWO PLACE DECIMAL ±0.010	WEIGHT: 51.420				NO SCALE		SHEET 2 OF 10		
THREE PLACE DECIMAL ±0.005									
INTERPRET GEOMETRIC TOLERANCING PER: ASME Y14.5 -2009									