

- NOTES:  
1. MATERIAL OF CONSTRUCTION IS 304 SS, BRUSHED #4.

UNLESS OTHERWISE SPECIFIED: ★	NAME	DATE
DIMENSIONS ARE IN INCHES	DRAWN	PE
TOLERANCES:	CHECKED	
FRACTIONAL: $\pm 1/32$	<b>PROPRIETARY AND CONFIDENTIAL</b> THE INFORMATION CONTAINED IN THIS DRAWING IS THE SOLE PROPERTY OF PEDESTALPRO LLC. ANY REPRODUCTION IN PART OR AS A WHOLE WITHOUT THE WRITTEN PERMISSION OF PEDESTALPRO LLC IS PROHIBITED.	
ANGULAR: $\pm 2^\circ$		
TWO PLACE DECIMAL $\pm 0.010$		
THREE PLACE DECIMAL $\pm 0.005$		
INTERPRET GEOMETRIC TOLERANCING PER: ASME Y14.5 -2009		

TITLE:		
INSTALLATION		
Wednesday, September 10, 2025 9:47:08 AM	SIZE <b>A</b>	PART NO. 812HOU-FANV-01-304
WEIGHT: 12.282	NO SCALE	REV <b>A</b>
SHEET 1 OF 7		

ITEM NO.	PART NUMBER	DESCRIPTION	QTY.
1	812HOU-FANV-01-304 ENCLOSURE	ENCLOSURE WELDMENT	1
2	812HOU-FANV-01-304 HOOD	HOOD	1
3	812HOU-FANV-01-304 DOOR	DOOR WELDMENT	1
4	i16S & i16SV BRACKET	DEVICE BRACKET	1
5	CAM LOCK	STRAIGHT CAM	1
6	HINGE	PIANO HINGE	1
7	GASKET SIDE	3/8" X .150 WEATHERSTRIPPING	2
8	GASKET TOP	3/8" X .150 WEATHERSTRIPPING	1
9	--	6-32 PAN HEAD SCREW	4
10	--	6-32 EXTERNAL TOOTH LOCK NUT	4

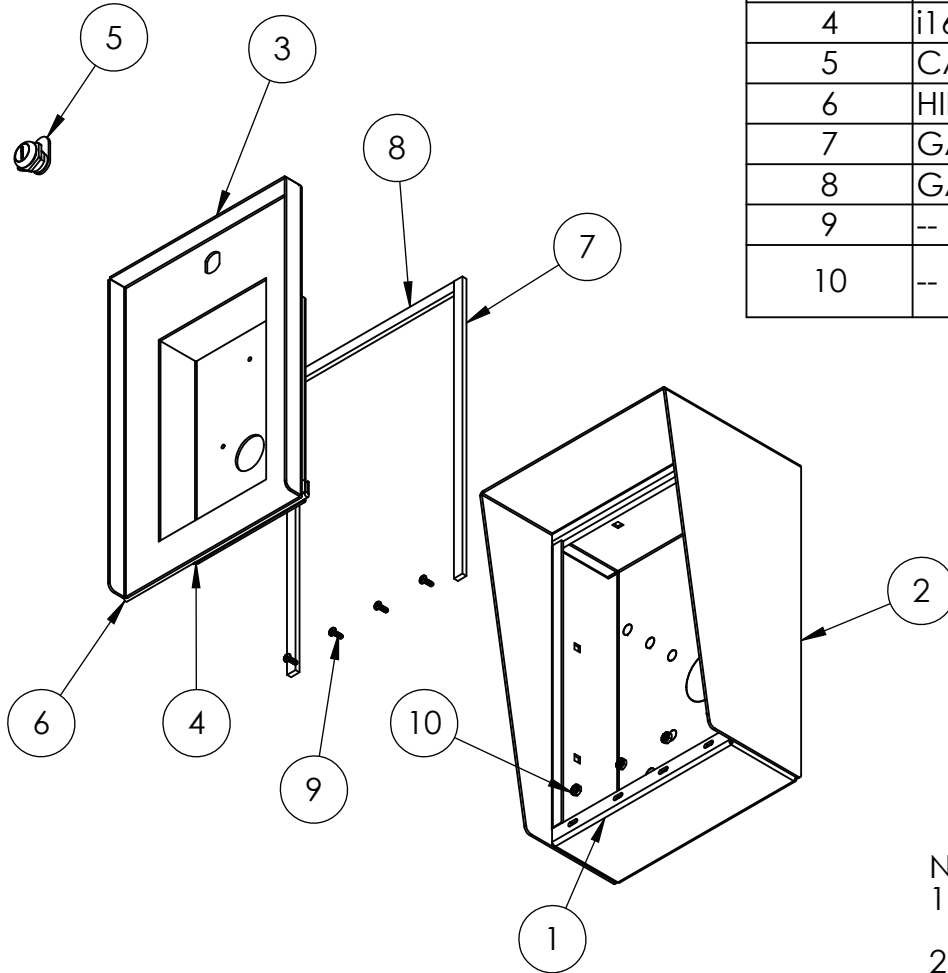

#### NOTES:

1. SEE STANDARD PREPARATION AND COATING INSTRUCTIONS FOR COATING PROCEDURE AND COLOR.
2. SEE STANDARD PACKAGING INSTRUCTIONS FOR PACKAGING PROCEDURE.

UNLESS OTHERWISE SPECIFIED:

DIMENSIONS ARE IN INCHES  
TOLERANCES:  
FRACTIONAL  $\pm 1/32$   
ANGULAR:  $\pm 2^\circ$   
TWO PLACE DECIMAL  $\pm 0.010$   
THREE PLACE DECIMAL  $\pm 0.005$

INTERPRET GEOMETRIC  
TOLERANCING PER:  
ASME Y14.5 -2009

DRAWN

CHECKED

#### PROPRIETARY AND CONFIDENTIAL

THE INFORMATION CONTAINED IN THIS  
DRAWING IS THE SOLE PROPERTY OF  
PEDESTALPRO LLC. ANY REPRODUCTION  
IN PART OR AS A WHOLE WITHOUT THE  
WRITTEN PERMISSION OF PEDESTALPRO LLC  
IS PROHIBITED.

NAME

DATE

TITLE:

ASSEMBLY

Wednesday, September  
10, 2025 9:47:08 AM

WEIGHT: 12.282

SIZE  
**A**

PART NO.  
812HOU-FANV-01-304

REV  
**A**

NO SCALE

SHEET 2 OF 7