

AVAILABLE CUTOUT AREA

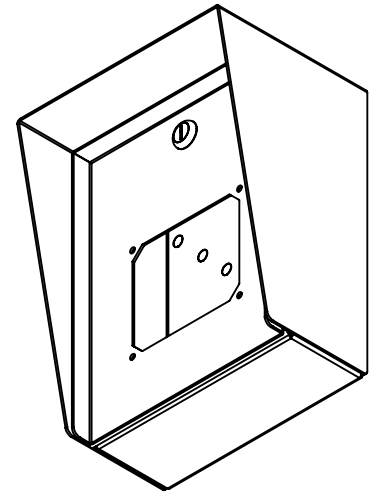

- NOTES:
1. MATERIAL OF CONSTRUCTION IS MILD STEEL.
 2. 2-4 MILS BLACK WRINKLE POWDER COAT.
 1. PWDR-BLACK-WRINKLE

<div>www.GooseneckStands.com</div> <div>(888) 378 - 1045</div> <div>Sales@GooseneckStands.com</div>	UNLESS OTHERWISE SPECIFIED: ★			TITLE:						
	DIMENSIONS ARE IN INCHES			DRAWN		PE		INSTALLATION		
	TOLERANCES:			CHECKED						
	FRACTIONAL: ±1/32			PROPRIETARY AND CONFIDENTIAL						
	ANGULAR: ±2°									
TWO PLACE DECIMAL ±0.010			THE INFORMATION CONTAINED IN THIS DRAWING IS THE SOLE PROPERTY OF PEDESTALPRO LLC. ANY REPRODUCTION IN PART OR AS A WHOLE WITHOUT THE WRITTEN PERMISSION OF PEDESTALPRO LLC IS PROHIBITED.							
THREE PLACE DECIMAL ±0.005										
INTERPRET GEOMETRIC TOLERANCING PER: ASME Y14.5 -2009			Wednesday, June 18, 2025 12:48:27 PM		SIZE A		PART NO. 810HOU-EYEL-01-CRS		REV C	
			WEIGHT: 9.204		NO SCALE			SHEET 1 OF 6		

ITEM NO.	PART NUMBER	DESCRIPTION	QTY.
1	810HOU-EYEL-01-CRS ENCLOSURE	ENCLOSURE WELDMENT	1
2	810HOU-EYEL-01-CRS DOOR	DOOR WELDMENT	1
3	810HOU-EYEL-01-CRS HOOD	HOOD	1
4	CAM LOCK	STRAIGHT CAM	1
5	HINGE	PIANO HINGE	1
6	GASKET SIDE	3/8" X .150 WEATHERSTRIPPING	2
7	GASKET TOP	3/8" X .150 WEATHERSTRIPPING	1
8	--	6-32 PAN HEAD SCREW	4
9	--	6-32 EXTERNAL TOOTH LOCK NUT	4

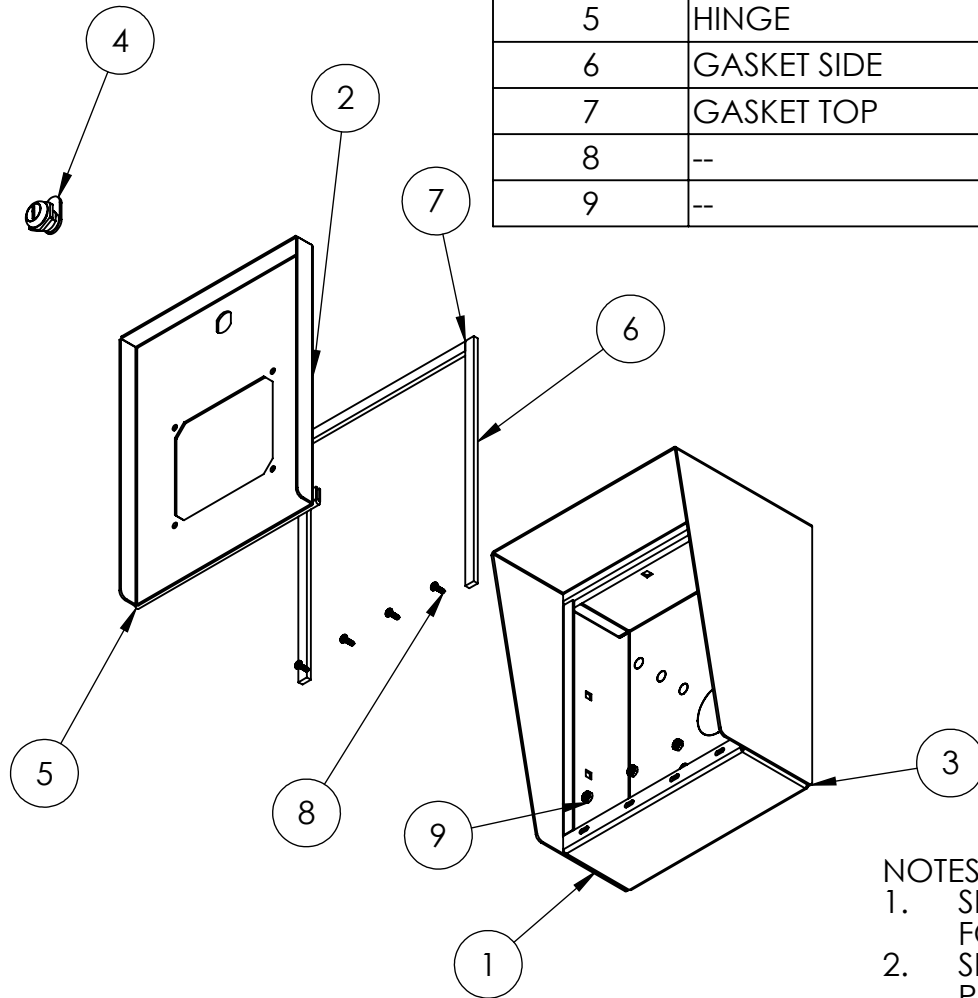

NOTES:

1. SEE STANDARD PREPARATION AND COATING INSTRUCTIONS FOR COATING PROCEDURE AND COLOR.
2. SEE STANDARD PACKAGING INSTRUCTIONS FOR PACKAGING PROCEDURE.

www.GooseneckStands.com

(888) 378 - 1045

Sales@GooseneckStands.com

UNLESS OTHERWISE SPECIFIED:

DIMENSIONS ARE IN INCHES
TOLERANCES:
FRACTIONAL $\pm 1/32$
ANGULAR: $\pm 2^\circ$
TWO PLACE DECIMAL ± 0.010
THREE PLACE DECIMAL ± 0.005

INTERPRET GEOMETRIC
TOLERANCING PER:
ASME Y14.5 -2009

NAME DATE

DRAWN

CHECKED

PROPRIETARY AND CONFIDENTIAL

THE INFORMATION CONTAINED IN THIS
DRAWING IS THE SOLE PROPERTY OF
PEDESTALPRO LLC. ANY REPRODUCTION
IN PART OR AS A WHOLE WITHOUT THE
WRITTEN PERMISSION OF PEDESTALPRO LLC
IS PROHIBITED.

TITLE:

ASSEMBLY

Wednesday, June 18, 2025
12:48:27 PM

WEIGHT: 9.204

SIZE
A

PART NO.
810HOU-EYEL-01-CRS

REV
C

NO SCALE

SHEET 2 OF 6