

AVAILABLE CUTOUT AREA

NOTES:

1. MATERIAL OF CONSTRUCTION IS MILD STEEL.
2. 2-4 MILS BLACK WRINKLE POWDER COAT.
1. PWDR-BLACK-WRINKLE

UNLESS OTHERWISE SPECIFIED: ★

DIMENSIONS ARE IN INCHES
TOLERANCES:
FRACTIONAL $\pm 1/32$
ANGULAR: $\pm 2^\circ$
TWO PLACE DECIMAL ± 0.010
THREE PLACE DECIMAL ± 0.005

INTERPRET GEOMETRIC
TOLERANCING PER:
ASME Y14.5 -2009

NAME	DATE
DRAWN	PE
CHECKED	

PROPRIETARY AND CONFIDENTIAL
THE INFORMATION CONTAINED IN THIS
DRAWING IS THE SOLE PROPERTY OF
PEDESTALPRO LLC. ANY REPRODUCTION
IN PART OR AS A WHOLE WITHOUT THE
WRITTEN PERMISSION OF PEDESTALPRO LLC
IS PROHIBITED.

TITLE:

INSTALLATION

Wednesday, August 6, 2025
3:22:11 PM

WEIGHT: 6.838

SIZE
A

PART NO.
68HOU-GALL-01-CRS

REV
C

NO SCALE

SHEET 1 OF 6

ITEM NO.	PART NUMBER	DESCRIPTION	QTY.
1	68HOU-GALL-01-CRS ENCLOSURE	ENCLOSURE WELDMENT	1
2	68HOU-GALL-01-CRS DOOR	DOOR WELDMENT	1
3	68HOU-GALL-01-CRS HOOD	HOOD	1
4	HINGE	PIANO HINGE	1
5	CAM LOCK	STRAIGHT CAM	1
6	GASKET SIDE	3/8" X .150 WEATHERSTRIPPING	2
7	GASKET TOP	3/8" X .150 WEATHERSTRIPPING	1
8	--	6-32 PAN HEAD SCREW	2
9	--	6-32 EXTERNAL TOOTH LOCK NUT	2

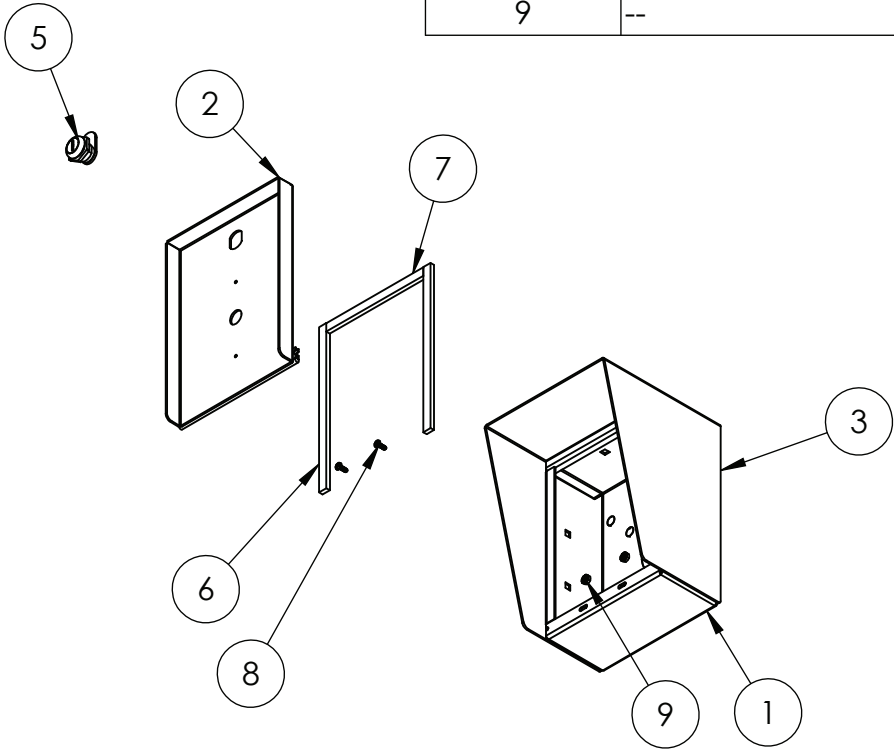

- NOTES:
- 1. SEE STANDARD PREPARATION AND COATING INSTRUCTIONS FOR COATING PROCEDURE AND COLOR.
 - 2. SEE STANDARD PACKAGING INSTRUCTIONS FOR PACKAGING PROCEDURE.

	UNLESS OTHERWISE SPECIFIED:		NAME	DATE	TITLE:		
	DIMENSIONS ARE IN INCHES	DRAWN			ASSEMBLY		
	TOLERANCES:	CHECKED					
	FRACTIONAL $\pm 1/32$	PROPRIETARY AND CONFIDENTIAL			Wednesday, August 6, 2025		
	ANGULAR: $\pm 2^\circ$	THE INFORMATION CONTAINED IN THIS DRAWING IS THE SOLE PROPERTY OF PEDESTALPRO LLC. ANY REPRODUCTION IN PART OR AS A WHOLE WITHOUT THE WRITTEN PERMISSION OF PEDESTALPRO LLC IS PROHIBITED.			3:22:11 PM	SIZE A	PART NO. 68HOU-GALL-01-CRS
	TWO PLACE DECIMAL ± 0.010				WEIGHT: 6.838	NO SCALE	REV C
	THREE PLACE DECIMAL ± 0.005						
	INTERPRET GEOMETRIC TOLERANCING PER: ASME Y14.5 -2009						SHEET 2 OF 6