

- NOTES:
1. MATERIAL OF CONSTRUCTION IS 304 SS, BRUSHED #4.

| | | | | | | | | |
|--|---|---|------|----------------------------|--|------------------|-----------------------------------|---------------------|
| UNLESS OTHERWISE SPECIFIED: | NAME | | DATE | TITLE: INSTALLATION | | | | |
| DIMENSIONS ARE IN INCHES TOLERANCES: FRACTIONAL ± 1/32 ANGULAR: ±2° TWO PLACE DECIMAL ±0.010 THREE PLACE DECIMAL ±0.005 | DRAWN | PE | | | | | | |
| | CHECKED | | | | | | | |
| | INTERPRET GEOMETRIC TOLERANCING PER: ASME Y14.5 -2009 | PROPRIETARY AND CONFIDENTIAL THE INFORMATION CONTAINED IN THIS DRAWING IS THE SOLE PROPERTY OF PEDESTALPRO LLC. ANY REPRODUCTION IN PART OR AS A WHOLE WITHOUT THE WRITTEN PERMISSION OF PEDESTALPRO LLC IS PROHIBITED. | | | Monday, August 11, 2025 11:45:14 AM | SIZE A | PART NO. 64TOW-LTSS-01-304 | REV A |
| WEIGHT: 33.696 | | | | | NO SCALE | | SHEET 1 OF 7 | |

| ITEM NO. | PART NUMBER | DESCRIPTION | QTY. |
|----------|-------------------|----------------------------------|------|
| 1 | 64TOW-LTSS-01-304 | TOWER WELDMENT | 1 |
| 2 | PLTCAP-46-46-30 | CAP | 1 |
| 3 | PLTACC-510 | ACCESS PANEL | 1 |
| 4 | PLTBAS-46-46 | BASE PLATE | 1 |
| 5 | -- | 8-32 X 1/2" SS BUTTON HEAD SCREW | 4 |

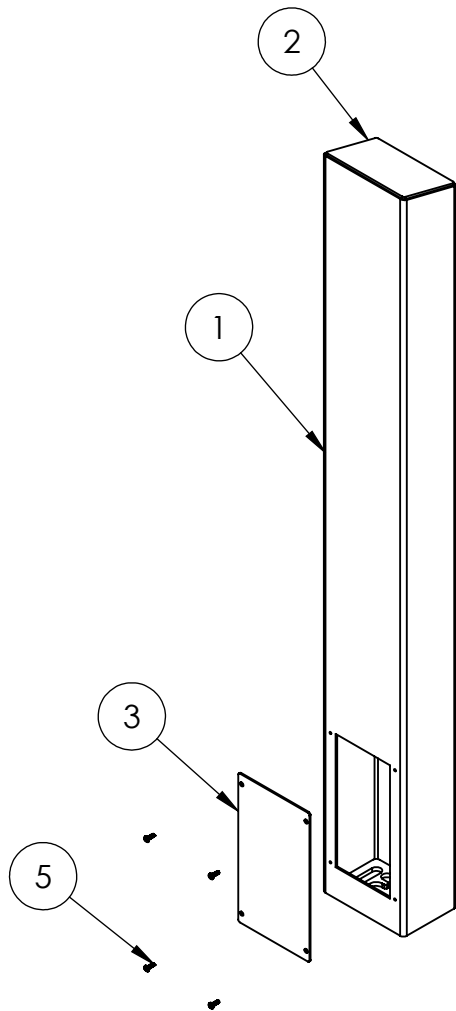

NOTES:

- SEE STANDARD PREPARATION AND COATING INSTRUCTIONS FOR COATING PROCEDURE AND COLOR.
- SEE STANDARD PACKAGING INSTRUCTIONS FOR PACKAGING PROCEDURE.

UNLESS OTHERWISE SPECIFIED:

DIMENSIONS ARE IN INCHES
TOLERANCES:
FRACTIONAL $\pm 1/32$
ANGULAR: $\pm 2^\circ$
TWO PLACE DECIMAL ± 0.010
THREE PLACE DECIMAL ± 0.005

INTERPRET GEOMETRIC
TOLERANCING PER:
ASME Y14.5 -2009

DRAWN

CHECKED

PROPRIETARY AND CONFIDENTIAL

THE INFORMATION CONTAINED IN THIS
DRAWING IS THE SOLE PROPERTY OF
PEDESTALPRO LLC. ANY REPRODUCTION
IN PART OR AS A WHOLE WITHOUT THE
WRITTEN PERMISSION OF PEDESTALPRO LLC
IS PROHIBITED.

NAME DATE

TITLE:

ASSEMBLY

Monday, August 11,
2025 11:45:14 AM

WEIGHT: 33.696

SIZE
A

PART NO.
64TOW-LTSS-01-304

REV
A

NO SCALE

SHEET 2 OF 7