

NOTES:

1. MATERIAL OF CONSTRUCTION IS 304 SS, BRUSHED #4.

<div>www.GooseneckStands.com</div> <div>(888) 378 - 1045</div> <div>Sales@GooseneckStands.com</div>	UNLESS OTHERWISE SPECIFIED:		NAME	DATE	TITLE: INSTALLATION				
	DIMENSIONS ARE IN INCHES TOLERANCES: FRACTIONAL ±1/32 ANGULAR: ±2° TWO PLACE DECIMAL ±0.010 THREE PLACE DECIMAL ±0.005	DRAWN			TUESDAY, JUNE 24, 2025 12:24:31 PM				
		CHECKED							
		PROPRIETARY AND CONFIDENTIAL THE INFORMATION CONTAINED IN THIS DRAWING IS THE SOLE PROPERTY OF PEDESTALPRO LLC. ANY REPRODUCTION IN PART OR AS A WHOLE WITHOUT THE WRITTEN PERMISSION OF PEDESTALPRO LLC IS PROHIBITED.							
	INTERPRET GEOMETRIC TOLERANCING PER: ASME Y14.5 -2009	WEIGHT: 33.341				SIZE A	PART NO. 64TOW-INNO-01-304	REV A	
				NO SCALE		SHEET 1 OF 7			

ITEM NO.	PART NUMBER	DESCRIPTION	QTY.
1	64TOW-INNO-01-304	TOWER WELDMENT	1
2	PLTCAP-46-46-30	CAP	1
3	PLTACC-510	ACCESS PANEL	1
4	PLTBAS-46-46	BASE PLATE	1
5	--	8-32 X 1/2" SS BUTTON HEAD SCREW	4

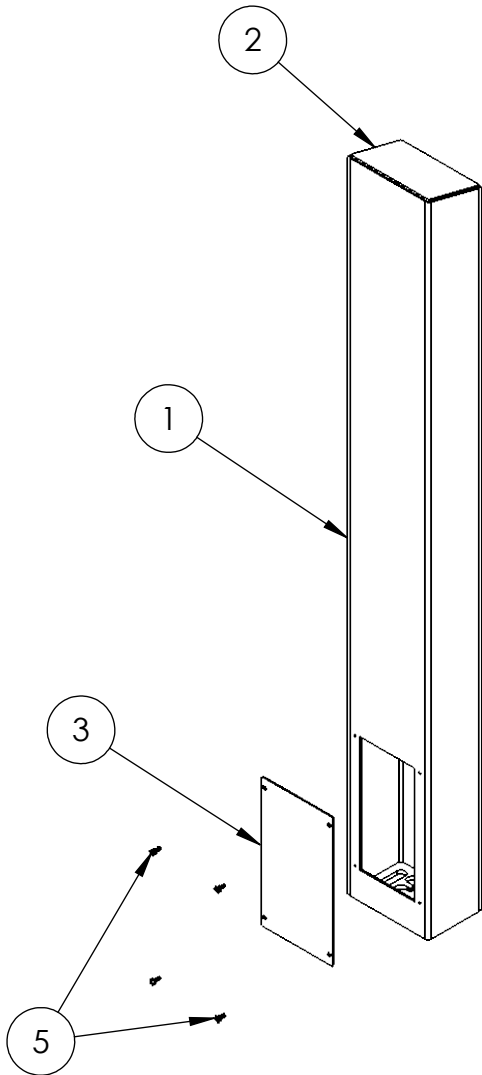

NOTES:

- SEE STANDARD PREPARATION AND COATING INSTRUCTIONS FOR COATING PROCEDURE AND COLOR.
- SEE STANDARD PACKAGING INSTRUCTIONS FOR PACKAGING PROCEDURE.

<div>www.GooseneckStands.com</div> <div>(888) 378 - 1045</div> <div>Sales@GooseneckStands.com</div>	UNLESS OTHERWISE SPECIFIED:		NAME		DATE		TITLE:			
	DIMENSIONS ARE IN INCHES TOLERANCES: FRACTIONAL ± 1/32 ANGULAR: ± 2° TWO PLACE DECIMAL ±0.010 THREE PLACE DECIMAL ±0.005		DRAWN				<div>ASSEMBLY</div> <div>TUESDAY, JUNE 24, 2025 12:24:31 PM</div>			
			CHECKED							
			PROPRIETARY AND CONFIDENTIAL							
	INTERPRET GEOMETRIC TOLERANCING PER: ASME Y14.5 -2009		THE INFORMATION CONTAINED IN THIS DRAWING IS THE SOLE PROPERTY OF PEDESTALPRO LLC. ANY REPRODUCTION IN PART OR AS A WHOLE WITHOUT THE WRITTEN PERMISSION OF PEDESTALPRO LLC IS PROHIBITED.		SIZE		PART NO.		REV	
			A		64TOW-INNO-01-304		A			
WEIGHT: 33.341				NO SCALE		SHEET 2 OF 7				