

- NOTES:
 1. MATERIAL OF CONSTRUCTION IS 304 SS, BRUSHED #4.

| | | | | | | |
|---|--|-------|------|---|---------------------|------------------|
| www.GooseneckStands.com (888) 378 - 1045 Sales@GooseneckStands.com | UNLESS OTHERWISE SPECIFIED: | NAME | DATE | TITLE: | | |
| | DIMENSIONS ARE IN INCHES TOLERANCES: FRACTIONAL $\pm 1/32$ ANGULAR: $\pm 2^\circ$ TWO PLACE DECIMAL ± 0.010 THREE PLACE DECIMAL ± 0.005 | DRAWN | | | INSTALLATION | |
| INTERPRET GEOMETRIC TOLERANCING PER: ASME Y14.5 -2009 | CHECKED | | | Wednesday, December 11, 2024 11:43:00 AM WEIGHT: 33.799 | | SIZE A |
| PROPRIETARY AND CONFIDENTIAL THE INFORMATION CONTAINED IN THIS DRAWING IS THE SOLE PROPERTY OF PEDESTALPRO LLC. ANY REPRODUCTION IN PART OR AS A WHOLE WITHOUT THE WRITTEN PERMISSION OF PEDESTALPRO LLC IS PROHIBITED. | | | | | NO SCALE | REV A |
| | | | | | SHEET 1 OF 8 | |

| ITEM NO. | PART NUMBER | DESCRIPTION | QTY. |
|----------|-------------------|----------------------------------|------|
| 1 | 64TOW-ALCY-01-304 | TOWER WELDMENT | 1 |
| 2 | PLTCAP-46-46-30 | CAP | 1 |
| 3 | PLABRA-AL-AI1000 | ALOCITY AI1000 BRACKET | 1 |
| 4 | PLTACC-510 | ACCESS PANEL | 1 |
| 5 | PLTBAS-46-46 | BASE PLATE | 1 |
| 6 | -- | 8-32 X 1/2" SS BUTTON HEAD SCREW | 4 |

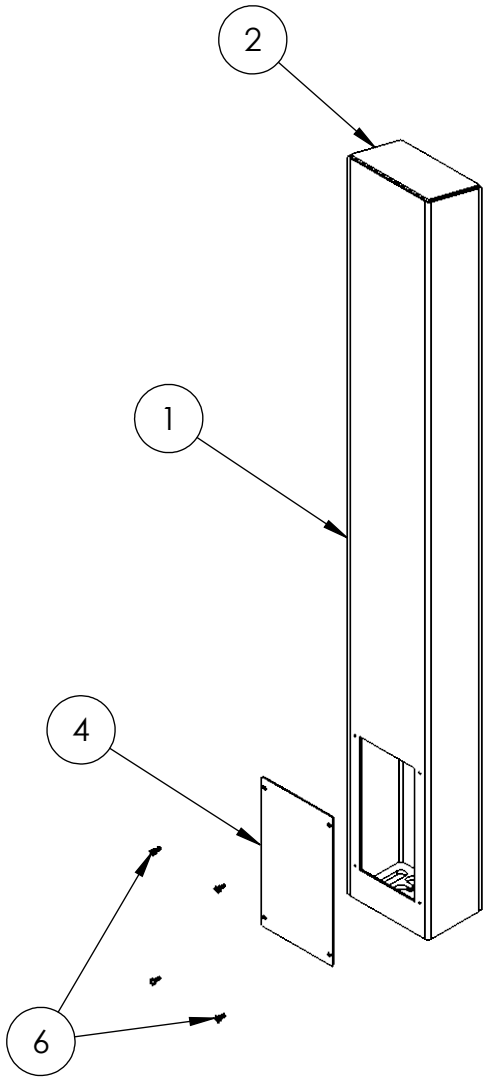

NOTES:

- SEE STANDARD PREPARATION AND COATING INSTRUCTIONS FOR COATING PROCEDURE AND COLOR.
- SEE STANDARD PACKAGING INSTRUCTIONS FOR PACKAGING PROCEDURE.

| | | | | | | |
|---|--|-------|------|----------|---|-------------------|
| www.GooseneckStands.com (888) 378 - 1045 Sales@GooseneckStands.com | UNLESS OTHERWISE SPECIFIED: | NAME | DATE | TITLE: | | |
| | DIMENSIONS ARE IN INCHES TOLERANCES: FRACTIONAL $\pm 1/32$ ANGULAR: $\pm 2^\circ$ TWO PLACE DECIMAL ± 0.010 THREE PLACE DECIMAL ± 0.005 | DRAWN | | | ASSEMBLY Wednesday, December 11, 2024 11:43:00 AM WEIGHT: 33.799 | SIZE |
| INTERPRET GEOMETRIC TOLERANCING PER: ASME Y14.5 -2009 | CHECKED | | | A | | 64TOW-ALCY-01-304 |
| PROPRIETARY AND CONFIDENTIAL THE INFORMATION CONTAINED IN THIS DRAWING IS THE SOLE PROPERTY OF PEDESTALPRO LLC. ANY REPRODUCTION IN PART OR AS A WHOLE WITHOUT THE WRITTEN PERMISSION OF PEDESTALPRO LLC IS PROHIBITED. | | | | | NO SCALE | SHEET 2 OF 8 |