

AVAILABLE CUTOUT AREA

- NOTES:
1. MATERIAL OF CONSTRUCTION IS MILD STEEL.
 2. 2-4 MILS BLACK WRINKLE POWDER COAT.
 1. PWDR-BLACK-WRINKLE

| | | | | | | | |
|-------------|---|---|---------------|------------------------|---|--------------|--------------------------------|
| <div></div> | UNLESS OTHERWISE SPECIFIED: ★ | NAME | DATE | TITLE: INSTALLATION | | | |
| | DIMENSIONS ARE IN INCHES TOLERANCES: FRACTIONAL ±1/32 ANGULAR: ±2° TWO PLACE DECIMAL ±0.010 THREE PLACE DECIMAL ±0.005 | DRAWN | PE | | | | |
| | | CHECKED | | | | | |
| | | PROPRIETARY AND CONFIDENTIAL | | | | | |
| | INTERPRET GEOMETRIC TOLERANCING PER: ASME Y14.5 -2009 | THE INFORMATION CONTAINED IN THIS DRAWING IS THE SOLE PROPERTY OF PEDESTALPRO LLC. ANY REPRODUCTION IN PART OR AS A WHOLE WITHOUT THE WRITTEN PERMISSION OF PEDESTALPRO LLC IS PROHIBITED. | | | Monday, September 8, 2025 3:26:40 PM | SIZE A | PART NO. 610HOU-FANV-01-CRS |
| | | | WEIGHT: 8.087 | NO SCALE | | SHEET 1 OF 6 | |

| ITEM NO. | PART NUMBER | DESCRIPTION | QTY. |
|----------|------------------------------|------------------------------|------|
| 1 | 610HOU-FANV-01-CRS ENCLOSURE | ENCLOSURE WELDMENT | 1 |
| 2 | 610HOU-FANV-01-CRS DOOR | DOOR WELDMENT | 1 |
| 3 | 610HOU-FANV-01-CRS HOOD | HOOD | 1 |
| 4 | CAM LOCK | STRAIGHT CAM | 1 |
| 5 | HINGE | PIANO HINGE | 1 |
| 6 | GASKET SIDE | 3/8" X .150 WEATHERSTRIPPING | 2 |
| 7 | GASKET TOP | 3/8" X .150 WEATHERSTRIPPING | 1 |
| 8 | -- | 6-32 PAN HEAD SCREW | 2 |
| 9 | -- | 6-32 EXTERNAL TOOTH LOCK NUT | 2 |

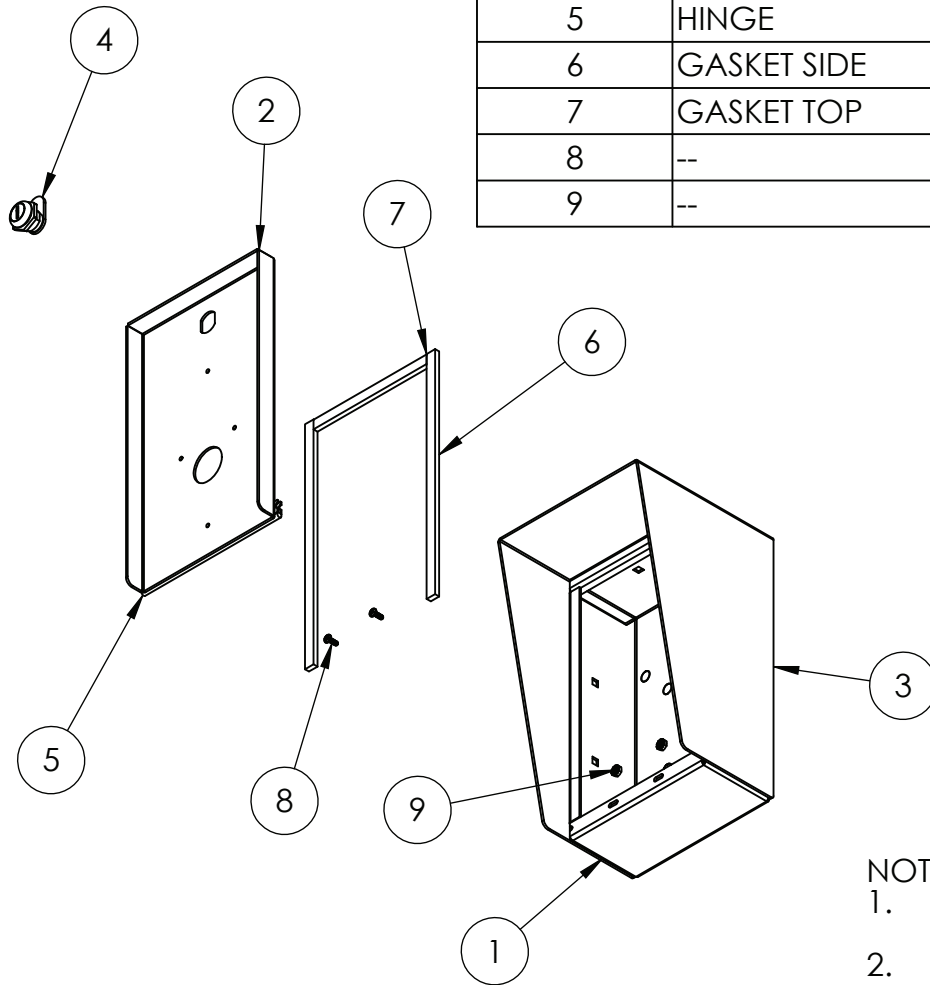

NOTES:

- SEE STANDARD PREPARATION AND COATING INSTRUCTIONS FOR COATING PROCEDURE AND COLOR.
- SEE STANDARD PACKAGING INSTRUCTIONS FOR PACKAGING PROCEDURE.

UNLESS OTHERWISE SPECIFIED:

DIMENSIONS ARE IN INCHES
TOLERANCES:
FRACTIONAL: $\pm 1/32$
ANGULAR: $\pm 2^\circ$
TWO PLACE DECIMAL ± 0.010
THREE PLACE DECIMAL ± 0.005

INTERPRET GEOMETRIC
TOLERANCING PER:
ASME Y14.5 -2009

NAME DATE

DRAWN

CHECKED

PROPRIETARY AND CONFIDENTIAL

THE INFORMATION CONTAINED IN THIS
DRAWING IS THE SOLE PROPERTY OF
PEDESTALPRO LLC. ANY REPRODUCTION
IN PART OR AS A WHOLE WITHOUT THE
WRITTEN PERMISSION OF PEDESTALPRO LLC
IS PROHIBITED.

TITLE:

ASSEMBLY

Monday, September 8,
2025 3:26:40 PM

WEIGHT: 8.087

SIZE
A

PART NO.
610HOU-FANV-01-CRS

REV
C

NO SCALE

SHEET 2 OF 6