

NOTES:
1. MATERIAL OF CONSTRUCTION IS 304 SS, BRUSHED #4.

UNLESS OTHERWISE SPECIFIED:	NAME	DATE
DIMENSIONS ARE IN INCHES	DRAWN	
TOLERANCES:	CHECKED	
FRACTIONAL $\pm 1/32$	PROPRIETARY AND CONFIDENTIAL THE INFORMATION CONTAINED IN THIS DRAWING IS THE SOLE PROPERTY OF PEDESTALPRO LLC. ANY REPRODUCTION IN PART OR AS A WHOLE WITHOUT THE WRITTEN PERMISSION OF PEDESTALPRO LLC IS PROHIBITED.	
ANGULAR: $\pm 2^\circ$		
TWO PLACE DECIMAL ± 0.010		
THREE PLACE DECIMAL ± 0.005		
INTERPRET GEOMETRIC TOLERANCING PER: ASME Y14.5 -2009		

TITLE:	SIZE	PART NO.	REV
INSTALLATION	A	5BOL-COID-01-304	A
Wednesday, December 10, 2025 11:05:47 AM WEIGHT: 36.643	NO SCALE	SHEET 1 OF 12	

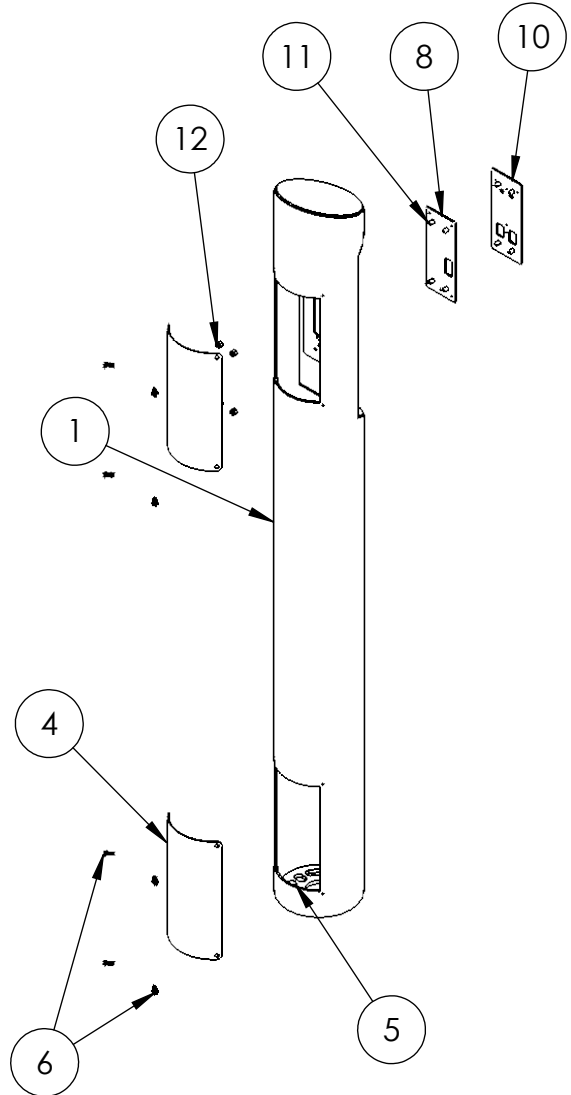

ITEM NO.	PART NUMBER	DESCRIPTION	QTY.
1	5BOL-COID-01-304	TOWER WELDMENT	1
2	5BOL-COID-01-304 TOP CAP	CAP	1
3	5BOL-COID-01-304 ALCOVE	FACE PLATE	1
4	5BOL-COID-01-304 ACCESS	ACCESS PANEL	2
5	5BOL-COID-01-304 BASE	BASE PLATE	1
6	--	8-32 X 1/2" SS BUTTON HEAD SCREW	8
8	5BOL-COID-01-304 FACEMAX PLATE	REMOVABEL MOUNTING PLATE	1
9	5BOL-COID-01-304 DEVICE FRAME	MOUNTING PLATE FRAME	1
10	5BOL-COID-01-304 FACEPRO PLATE	REMOVABEL MOUNTING PLATE	1
11	--	8-32 X 1/2" SS PEM STUD	8
12	--	8-32 SS NYLON LOCK NUT	4

- NOTES:
- 1. SEE STANDARD PREPARATION AND COATING INSTRUCTIONS FOR COATING PROCEDURE AND COLOR.
 - 2. SEE STANDARD PACKAGING INSTRUCTIONS FOR PACKAGING PROCEDURE.

UNLESS OTHERWISE SPECIFIED:

DIMENSIONS ARE IN INCHES
TOLERANCES:
FRACTIONAL $\pm 1/32$
ANGULAR: $\pm 2^\circ$
TWO PLACE DECIMAL ± 0.010
THREE PLACE DECIMAL ± 0.005

INTERPRET GEOMETRIC
TOLERANCING PER:
ASME Y14.5 -2009

DRAWN

CHECKED

PROPRIETARY AND CONFIDENTIAL
THE INFORMATION CONTAINED IN THIS
DRAWING IS THE SOLE PROPERTY OF
PEDESTALPRO LLC. ANY REPRODUCTION
IN PART OR AS A WHOLE WITHOUT THE
WRITTEN PERMISSION OF PEDESTALPRO LLC
IS PROHIBITED.

NAME

DATE

TITLE:

ASSEMBLY

Wednesday,
December 10, 2025
11:05:47 AM
WEIGHT: 37.108

SIZE
A

PART NO.
5BOL-COID-01-304

REV
A

NO SCALE

SHEET 2 OF 12