

CONTROL ID
IDUHF LITE

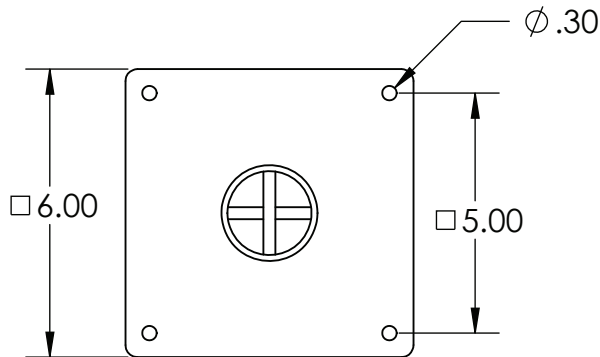
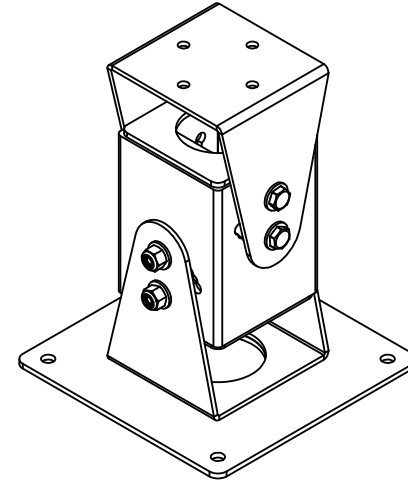
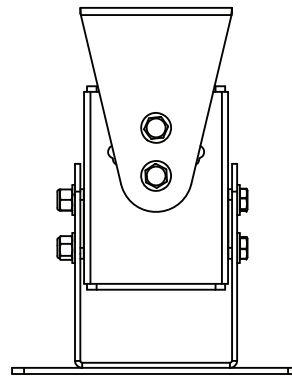
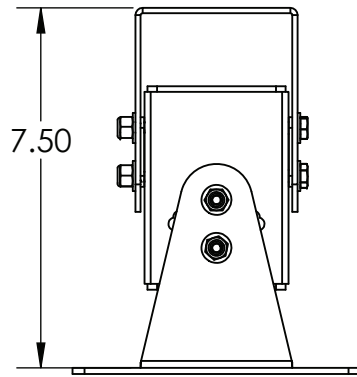

NOTES:

1. MATERIAL OF CONSTRUCTION IS 304SS.
2. 2-4 MILS BLACK WRINKLE POWDER COAT.
1. PWDR-BLACK-WRINKLE

UNLESS OTHERWISE SPECIFIED:

DIMENSIONS ARE IN INCHES
TOLERANCES:
FRACTIONAL $\pm 1/32$
ANGULAR: $\pm 2^\circ$
TWO PLACE DECIMAL ± 0.010
THREE PLACE DECIMAL ± 0.005

INTERPRET GEOMETRIC
TOLERANCING PER:
ASME Y14.5 -2009

DRAWN
CHECKED

NAME DATE

PROPRIETARY AND CONFIDENTIAL

THE INFORMATION CONTAINED IN THIS
DRAWING IS THE SOLE PROPERTY OF
PEDESTALPRO LLC. ANY REPRODUCTION
IN PART OR AS A WHOLE WITHOUT THE
WRITTEN PERMISSION OF PEDESTALPRO LLC
IS PROHIBITED.

TITLE:

INSTALLATION

Monday, November 3,
2025 1:08:35 PM

WEIGHT:

SIZE
A

PART NO.
33OMNI-COID-01-304

REV
A

NO SCALE

SHEET 1 OF 8

ITEM NO.	PART NUMBER	DESCRIPTION	QTY.
1	33OMNI-COID-01-304 TUBE	2X2 SQ STEEL TUBE	1
2	33OMNI-COID-01-304 SWIVEL CLAMP 2	SWIVEL	1
3	33OMNI-COID-01-304 TUBE CAP	CAP PLATE	2
4	--	1/4-20 ZINC PLATED NYLON LOCK NUT	4
5	33OMNI-COID-01-304 SPACER	SPACER	4
6	33OMNI-COID-01-304 SWIVEL CLAMP 1	SWIVEL	1
7	--	1/4-20 X 3.75" SS HHCS PARTIAL THREAD	4
8	--	1/4" SS WASHER	8
9	33OMNI-COID-01-304	FACEPLATE	1

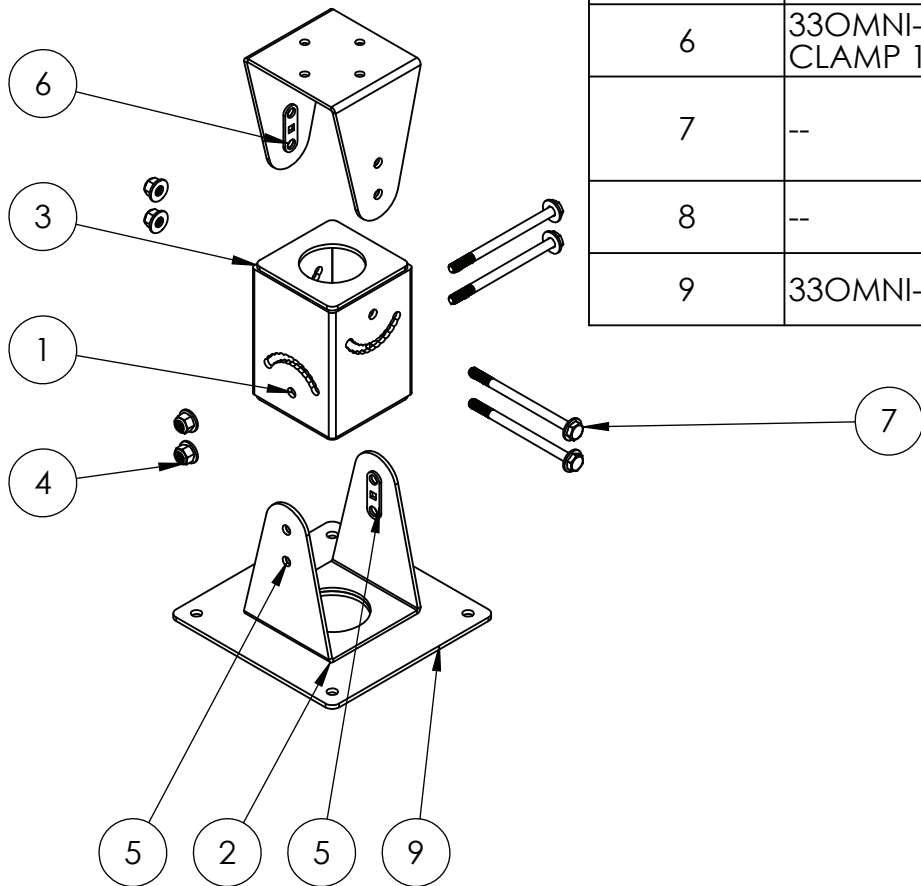

UNLESS OTHERWISE SPECIFIED:

DIMENSIONS ARE IN INCHES
TOLERANCES:
FRACTIONAL $\pm 1/32$
ANGULAR: $\pm 2^\circ$
TWO PLACE DECIMAL ± 0.010
THREE PLACE DECIMAL ± 0.005

INTERPRET GEOMETRIC
TOLERANCING PER:
ASME Y14.5 -2009

DRAWN

CHECKED

PROPRIETARY AND CONFIDENTIAL

THE INFORMATION CONTAINED IN THIS
DRAWING IS THE SOLE PROPERTY OF
PEDESTALPRO LLC. ANY REPRODUCTION
IN PART OR AS A WHOLE WITHOUT THE
WRITTEN PERMISSION OF PEDESTALPRO LLC
IS PROHIBITED.

NAME

DATE

TITLE:

ASSEMBLY

Monday, November 3,
2025 1:08:35 PM

WEIGHT:

SIZE
A

PART NO.
33OMNI-COID-01-304

REV
A

NO SCALE

SHEET 2 OF 8