

NOTES:  
1. MATERIAL OF CONSTRUCTION IS 304 SS, BRUSHED #4.

<div>www.GooseneckStands.com</div> <div>(888) 378 - 1045</div> <div>Sales@GooseneckStands.com</div>	UNLESS OTHERWISE SPECIFIED:		NAME	DATE	TITLE:					
	DIMENSIONS ARE IN INCHES TOLERANCES: FRACTIONAL ± 1/32 ANGULAR: ± 2° TWO PLACE DECIMAL ±0.010 THREE PLACE DECIMAL ±0.005	DRAWN	PE		INSTALLATION					
		CHECKED								
		PROPRIETARY AND CONFIDENTIAL								
		THE INFORMATION CONTAINED IN THIS DRAWING IS THE SOLE PROPERTY OF PEDESTALPRO LLC. ANY REPRODUCTION IN PART OR AS A WHOLE WITHOUT THE WRITTEN PERMISSION OF PEDESTALPRO LLC IS PROHIBITED.				TUESDAY, MAY 20, 2025 11:32:01 AM		SIZE A	PART NO. 175CAB-KANT-01-304	REV A
	INTERPRET GEOMETRIC TOLERANCING PER: ASME Y14.5 -2009				WEIGHT: 85.425		NO SCALE		SHEET 1 OF 10	

ITEM NO.	PART NUMBER	DESCRIPTION	QTY.
1	175CAB-KANT-01-304 MAIN BODY	MAIN BODY	1
2	175CAB-KANT-01-304 TOP	TOP	1
3	175CAB-KANT-01-304 ACCESS PANEL	ACCESS PANEL	1
4	175CAB-KANT-01-304 BACK CLOSURE	BACK CLOSURE	1
5	175CAB-KANT-01-304 BASE PLATE	BASE PLATE	1
6	12GA STIFFENER	STIFFENER	1
7	--	8-32 X 1/2" SS PAN HEAD SCREW	10
8	PLABRA-KT-KTES	BRACKET	1

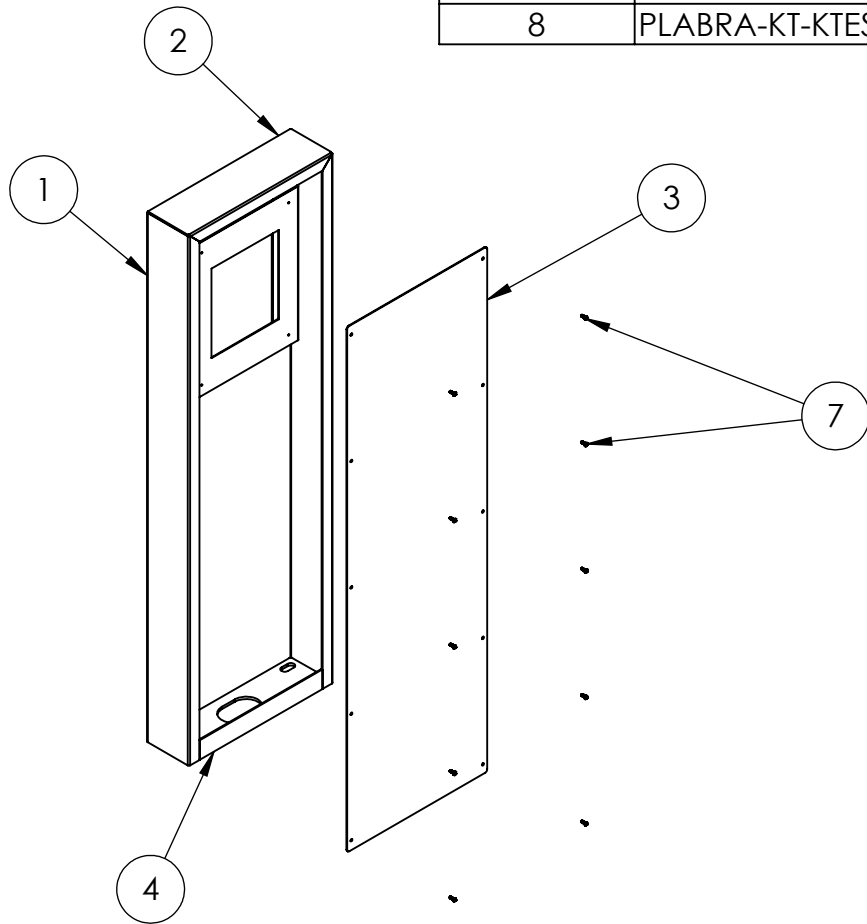

#### NOTES:

- SEE STANDARD PREPARATION AND COATING INSTRUCTIONS FOR COATING PROCEDURE AND COLOR.
- SEE STANDARD PACKAGING INSTRUCTIONS FOR PACKAGING PROCEDURE.

<div>www.GooseneckStands.com</div> <div>(888) 378 - 1045</div> <div>Sales@GooseneckStands.com</div>	UNLESS OTHERWISE SPECIFIED:		NAME	DATE	TITLE:					
	DIMENSIONS ARE IN INCHES TOLERANCES: FRACTIONAL ± 1/32 ANGULAR: ± 2° TWO PLACE DECIMAL ±0.010 THREE PLACE DECIMAL ±0.005	DRAWN			ASSEMBLY					
		CHECKED								
		PROPRIETARY AND CONFIDENTIAL				TUESDAY, MAY 20, 2025				
	THE INFORMATION CONTAINED IN THIS DRAWING IS THE SOLE PROPERTY OF PEDESTALPRO LLC. ANY REPRODUCTION IN PART OR AS A WHOLE WITHOUT THE WRITTEN PERMISSION OF PEDESTALPRO LLC IS PROHIBITED.				11:32:01 AM					
INTERPRET GEOMETRIC TOLERANCING PER: ASME Y14.5 -2009					SIZE	PART NO.	REV			
					A	175CAB-KANT-01-304	A			
					WEIGHT: 85.425		NO SCALE		SHEET 2 OF 10	