

1. MATERIAL OF CONSTRUCTION IS 304 SS, BRUSHED #4.

<div>www.GooseneckStands.com</div> <div>(888) 378 - 1045</div> <div>Sales@GooseneckStands.com</div>	UNLESS OTHERWISE SPECIFIED:		NAME	DATE	TITLE: INSTALLATION				
	DIMENSIONS ARE IN INCHES TOLERANCES: FRACTIONAL ±1/32 ANGULAR: ±2° TWO PLACE DECIMAL ±0.010 THREE PLACE DECIMAL ±0.005	DRAWN			Tuesday, July 29, 2025 2:53:08 PM				
		CHECKED							
		PROPRIETARY AND CONFIDENTIAL THE INFORMATION CONTAINED IN THIS DRAWING IS THE SOLE PROPERTY OF PEDESTALPRO LLC. ANY REPRODUCTION IN PART OR AS A WHOLE WITHOUT THE WRITTEN PERMISSION OF PEDESTALPRO LLC IS PROHIBITED.							
	INTERPRET GEOMETRIC TOLERANCING PER: ASME Y14.5 -2009	WEIGHT: 107.971				SIZE A	PART NO. 174KIO-PPRO-01-304	REV A	
				NO SCALE		SHEET 1 OF 12			

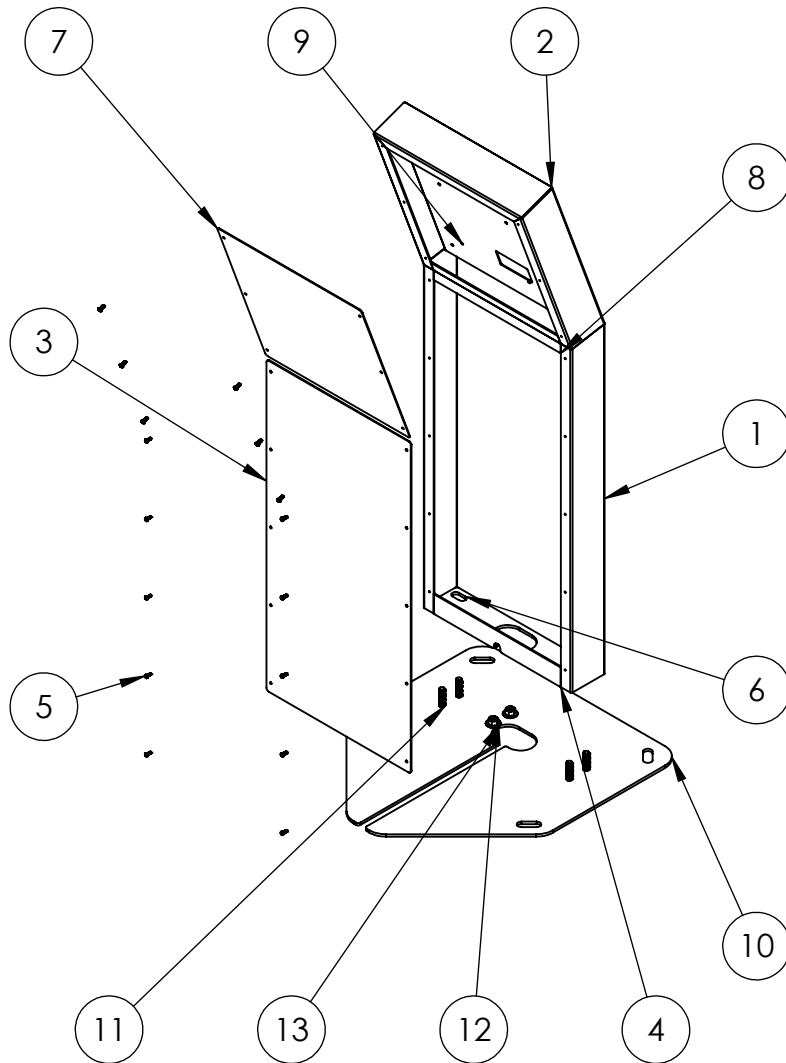

ITEM NO.	PART NUMBER	DESCRIPTION	QTY.
1	174KIO-PPRO-01-304	MAIN BODY	1
2	174KIO-PPRO-01-304	TOP	1
3	174KIO-PPRO-01-304	ACCESS PANEL	1
4	174KIO-PPRO-01-304	BACK CLOSURE	1
5	--	8-32 X 1/2" SS PAN HEAD SCREW	16
6	174KIO-PPRO-01-304	BASE PLATE	1
7	174KIO-PPRO-01-304	ACCESS PANEL UPPER	1
8	174KIO-PPRO-01-304	MIDDLE CLOSURE	1
9	MX-SS-12F V2	DEVICE MOUNTING PLATE	1
10	174KIO-PPRO-01-304	FREE STANDING BASE PLATE	1
11	--	1/2"-13 X 2" STEEL THREADED ROD	4
12	--	1/2"-13 HEX NUT	4
13	--	1/2" WASHER	4

NOTES:

- SEE STANDARD PREPARATION AND COATING INSTRUCTIONS FOR COATING PROCEDURE AND COLOR.
- SEE STANDARD PACKAGING INSTRUCTIONS FOR PACKAGING PROCEDURE.

www.GooseneckStands.com

(888) 378 - 1045

Sales@GooseneckStands.com

UNLESS OTHERWISE SPECIFIED:

DIMENSIONS ARE IN INCHES
TOLERANCES:
FRACTIONAL $\pm 1/32$
ANGULAR: $\pm 2^\circ$
TWO PLACE DECIMAL ± 0.010
THREE PLACE DECIMAL ± 0.005

INTERPRET GEOMETRIC
TOLERANCING PER:
ASME Y14.5 -2009

NAME DATE

DRAWN

CHECKED

PROPRIETARY AND CONFIDENTIAL

THE INFORMATION CONTAINED IN THIS
DRAWING IS THE SOLE PROPERTY OF
PEDESTALPRO LLC. ANY REPRODUCTION
IN PART OR AS A WHOLE WITHOUT THE
WRITTEN PERMISSION OF PEDESTALPRO LLC
IS PROHIBITED.

TITLE:

ASSEMBLY

Tuesday, July 29, 2025
2:53:08 PM

WEIGHT: 107.971

SIZE
A

PART NO.
174KIO-PPRO-01-304

REV
A

NO SCALE

SHEET 2 OF 12