

- NOTES:
1. MATERIAL OF CONSTRUCTION IS 304 SS, BRUSHED #4.

www.GooseneckStands.com

(888) 378 - 1045

Sales@GooseneckStands.com

UNLESS OTHERWISE SPECIFIED:

DIMENSIONS ARE IN INCHES
TOLERANCES:
FRACTIONAL $\pm 1/32$
ANGULAR: $\pm 2^\circ$
TWO PLACE DECIMAL ± 0.010
THREE PLACE DECIMAL ± 0.005

INTERPRET GEOMETRIC
TOLERANCING PER:
ASME Y14.5 -2009

NAME DATE

DRAWN

PE

CHECKED

PROPRIETARY AND CONFIDENTIAL

THE INFORMATION CONTAINED IN THIS
DRAWING IS THE SOLE PROPERTY OF
PEDESTALPRO LLC. ANY REPRODUCTION
IN PART OR AS A WHOLE WITHOUT THE
WRITTEN PERMISSION OF PEDESTALPRO LLC
IS PROHIBITED.

TITLE:

INSTALLATION

MONDAY, JUNE 16,
2025 10:14:08 AM

WEIGHT: 71.031

SIZE
A

PART NO.
144CAB-DOOR-01-304

REV
A

NO SCALE

SHEET 1 OF 10

ITEM NO.	PART NUMBER	DESCRIPTION	QTY.
1	144CAB-DOOR-01-304 MAIN BODY	MAIN BODY	1
2	144CAB-DOOR-01-304 TOP	TOP	1
3	144CAB-DOOR-01-304 ACCESS PANEL	ACCESS PANEL	1
4	144CAB-DOOR-01-304 BACK CLOSURE	BACK CLOSURE	1
5	144CAB-DOOR-01-304 BASE PLATE	BASE PLATE	1
6	D31TDH FLUSH BRACKET	BRACKET	1
7	12GA STIFFENER	STIFFENER	1
8	--	8-32 X 1/2" SS PAN HEAD SCREW	10

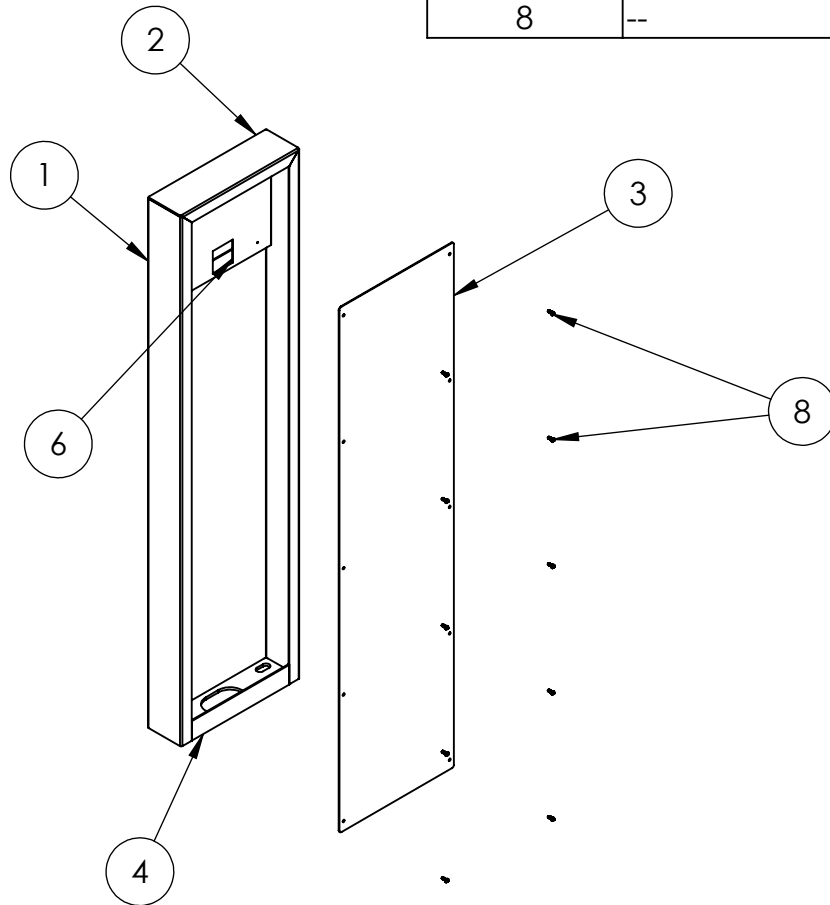

NOTES:

- SEE STANDARD PREPARATION AND COATING INSTRUCTIONS FOR COATING PROCEDURE AND COLOR.
- SEE STANDARD PACKAGING INSTRUCTIONS FOR PACKAGING PROCEDURE.

<div>www.GooseneckStands.com</div> <div>(888) 378 - 1045</div> <div>Sales@GooseneckStands.com</div>	UNLESS OTHERWISE SPECIFIED:			NAME	DATE	TITLE: ASSEMBLY				
	DIMENSIONS ARE IN INCHES TOLERANCES: FRACTIONAL ±1/32 ANGULAR: ±2° TWO PLACE DECIMAL ±0.010 THREE PLACE DECIMAL ±0.005		DRAWN			MONDAY, JUNE 16, 2025 10:14:08 AM				
			CHECKED							
	INTERPRET GEOMETRIC TOLERANCING PER: ASME Y14.5 -2009		PROPRIETARY AND CONFIDENTIAL							
			THE INFORMATION CONTAINED IN THIS DRAWING IS THE SOLE PROPERTY OF PEDESTALPRO LLC. ANY REPRODUCTION IN PART OR AS A WHOLE WITHOUT THE WRITTEN PERMISSION OF PEDESTALPRO LLC IS PROHIBITED.							
		WEIGHT: 71.031			NO SCALE		SHEET 2 OF 10			