

NOTES:

- MATERIAL OF CONSTRUCTION IS 304 SS, BRUSHED #4.

<div>www.GooseneckStands.com</div> <div>(888) 378 - 1045</div> <div>Sales@GooseneckStands.com</div>	UNLESS OTHERWISE SPECIFIED: ★	NAME	DATE	TITLE: INSTALLATION					
	DIMENSIONS ARE IN INCHES TOLERANCES: FRACTIONAL ±1/32 ANGULAR: ±2° TWO PLACE DECIMAL ±0.010 THREE PLACE DECIMAL ±0.005	DRAWN	PE		Monday, June 16, 2025 11:08:54 AM				
		CHECKED							
		PROPRIETARY AND CONFIDENTIAL THE INFORMATION CONTAINED IN THIS DRAWING IS THE SOLE PROPERTY OF PEDESTALPRO LLC. ANY REPRODUCTION IN PART OR AS A WHOLE WITHOUT THE WRITTEN PERMISSION OF PEDESTALPRO LLC IS PROHIBITED.							
	INTERPRET GEOMETRIC TOLERANCING PER: ASME Y14.5 -2009				SIZE A	PART NO. 1412HOU-DOOR-01-304		REV A	
			NO SCALE		SHEET 1 OF 7				
				WEIGHT: 17.477					

ITEM NO.	PART NUMBER	DESCRIPTION	QTY.
1	1412HOU-DOOR-01-304 ENCLOSURE	ENCLOSURE WELDMENT	1
2	1412HOU-DOOR-01-304 DOOR	DOOR WELDMENT	1
3	1412HOU-DOOR-01-304 HOOD	HOOD	1
4	D31TDH FLUSH BRACKET	BRACKET	1
5	CAM LOCK	STRAIGHT CAM	1
6	HINGE	PIANO HINGE	1
7	GASKET SIDE	3/8" X .150 WEATHERSTRIPPING	2
8	GASKET TOP	3/8" X .150 WEATHERSTRIPPING	1
9	--	6-32 PAN HEAD SCREW	6
10	--	6-32 EXTERNAL TOOTH LOCK NUT	6

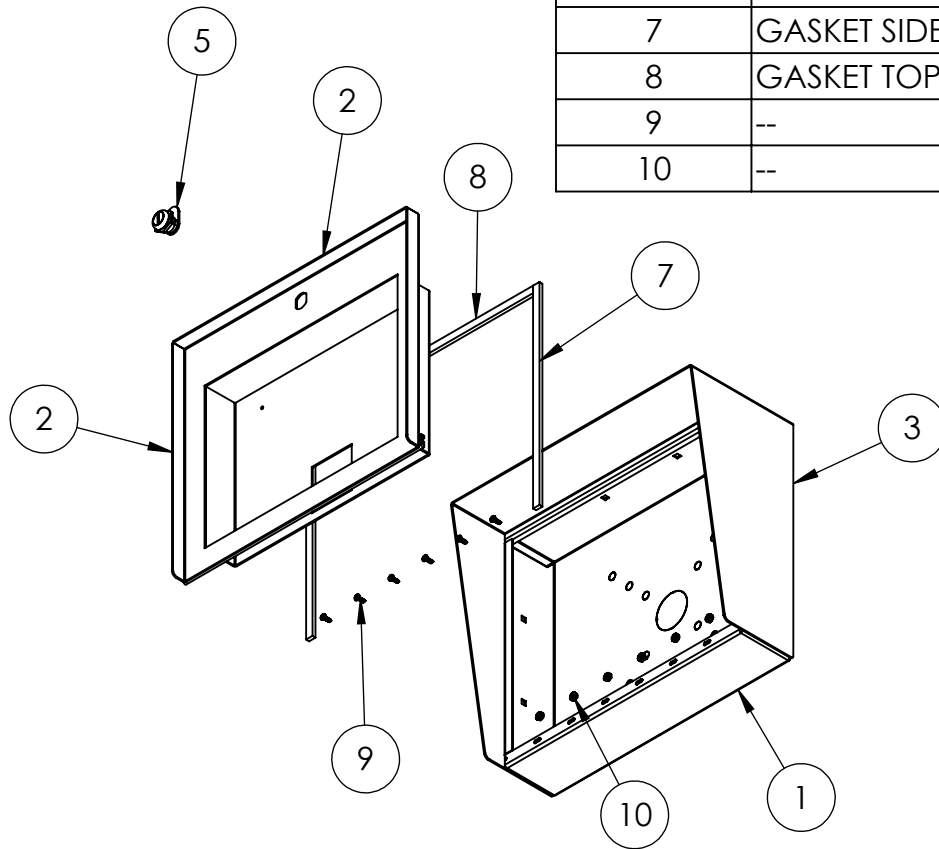

NOTES:

- SEE STANDARD PREPARATION AND COATING INSTRUCTIONS FOR COATING PROCEDURE AND COLOR.
- SEE STANDARD PACKAGING INSTRUCTIONS FOR PACKAGING PROCEDURE.

<div>www.GooseneckStands.com</div> <div>(888) 378 - 1045</div> <div>Sales@GooseneckStands.com</div>	UNLESS OTHERWISE SPECIFIED:		NAME	DATE	TITLE:				
	DIMENSIONS ARE IN INCHES TOLERANCES: FRACTIONAL ± 1/32 ANGULAR: ± 2° TWO PLACE DECIMAL ± 0.010 THREE PLACE DECIMAL ± 0.005	DRAWN			ASSEMBLY				
		CHECKED							
		PROPRIETARY AND CONFIDENTIAL							
	THE INFORMATION CONTAINED IN THIS DRAWING IS THE SOLE PROPERTY OF PEDESTALPRO LLC. ANY REPRODUCTION IN PART OR AS A WHOLE WITHOUT THE WRITTEN PERMISSION OF PEDESTALPRO LLC IS PROHIBITED.				Monday, June 16, 2025 11:08:54 AM		SIZE A	PART NO. 1412HOU-DOOR-01-304	REV A
INTERPRET GEOMETRIC TOLERANCING PER: ASME Y14.5 -2009					WEIGHT: 17.477		NO SCALE		SHEET 2 OF 7