

BD	PE
DXF	PE
DIM	PE
DXF	PE

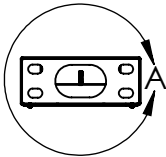
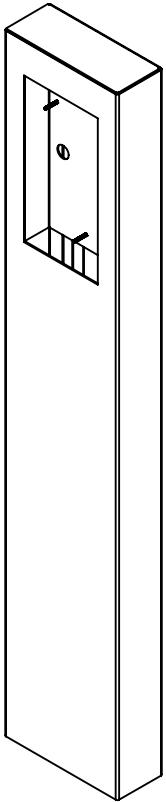
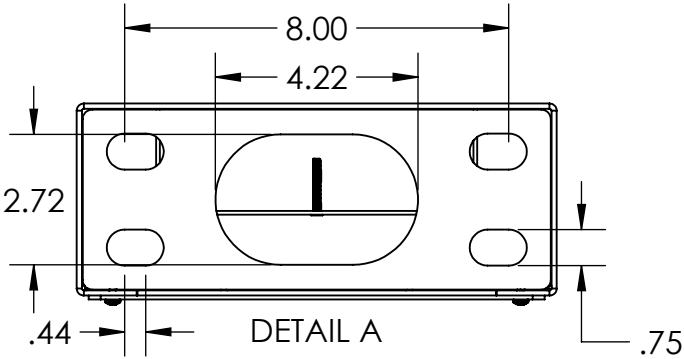
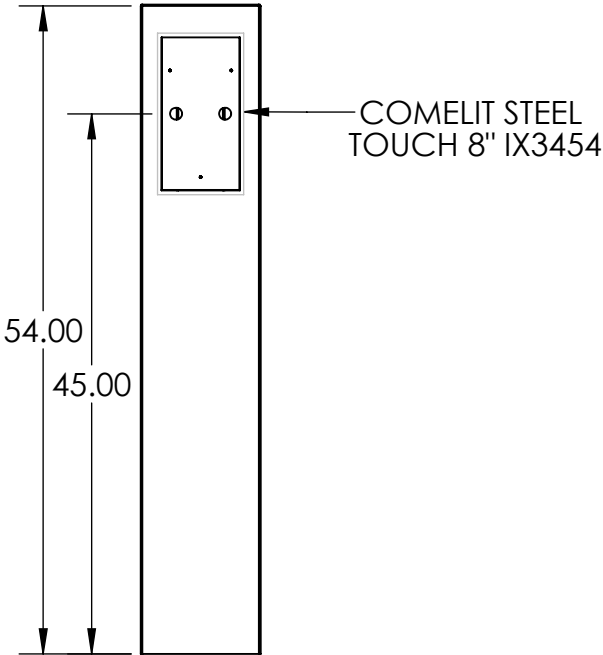
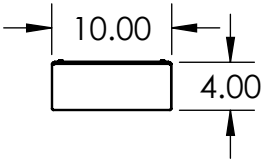

NOTES:  
1. MATERIAL OF CONSTRUCTION IS 304 SS, BRUSHED #4.

<div>www.GooseneckStands.com</div> <div>(888) 378 - 1045</div> <div>Sales@GooseneckStands.com</div>	UNLESS OTHERWISE SPECIFIED:		NAME		DATE		TITLE: <div>INSTALLATION</div>					
	DIMENSIONS ARE IN INCHES TOLERANCES: FRACTIONAL ± 1/32 ANGULAR: ±2° TWO PLACE DECIMAL ±0.010 THREE PLACE DECIMAL ±0.005		DRAWN		PE							
			CHECKED									
	INTERPRET GEOMETRIC TOLERANCING PER: ASME Y14.5 -2009		PROPRIETARY AND CONFIDENTIAL				THURSDAY, JULY 3, 2025 1:15:43 PM		SIZE <div>A</div>	PART NO. 104CAB-COME-01-304		REV <div>A</div>
			THE INFORMATION CONTAINED IN THIS DRAWING IS THE SOLE PROPERTY OF PEDESTALPRO LLC. ANY REPRODUCTION IN PART OR AS A WHOLE WITHOUT THE WRITTEN PERMISSION OF PEDESTALPRO LLC IS PROHIBITED.				WEIGHT: 58.224		NO SCALE		SHEET 1 OF 10	

ITEM NO.	PART NUMBER	DESCRIPTION	QTY.
1	104CAB-COME-01-304 MAIN BODY	MAIN BODY	1
2	104CAB-COME-01-304 TOP	TOP	1
3	104CAB-COME-01-304 ACCESS PANEL	ACCESS PANEL	1
4	104CAB-COME-01-304 BACK CLOSURE	BACK CLOSURE	1
5	104CAB-COME-01-304 BASE PLATE	BASE PLATE	1
6	12GA STIFFENER	STIFFENER	1
7	93580A598	M4 X 0.7 X 30MM PEM STUD	3
8	IX3454	FLUSH MOUNT BRACKET	1
9	--	8-32 X 1/2" PAN HEAD SCREW	10

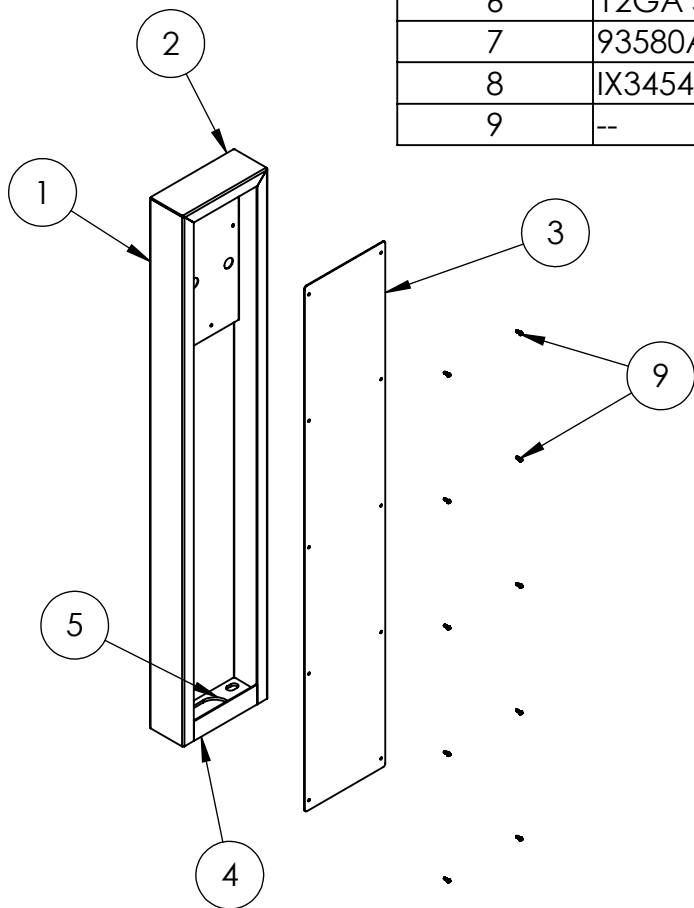

#### NOTES:

1. SEE STANDARD PREPARATION AND COATING INSTRUCTIONS FOR COATING PROCEDURE AND COLOR.
2. SEE STANDARD PACKAGING INSTRUCTIONS FOR PACKAGING PROCEDURE.

<div>www.GooseneckStands.com</div> <div>(888) 378 - 1045</div> <div>Sales@GooseneckStands.com</div>	UNLESS OTHERWISE SPECIFIED:		NAME	DATE	TITLE:				
	DIMENSIONS ARE IN INCHES TOLERANCES: FRACTIONAL ±1/32 ANGULAR: ±2° TWO PLACE DECIMAL ±0.010 THREE PLACE DECIMAL ±0.005	DRAWN			ASSEMBLY				
		CHECKED							
		PROPRIETARY AND CONFIDENTIAL							
	INTERPRET GEOMETRIC TOLERANCING PER: ASME Y14.5 -2009	THE INFORMATION CONTAINED IN THIS DRAWING IS THE SOLE PROPERTY OF PEDESTALPRO LLC. ANY REPRODUCTION IN PART OR AS A WHOLE WITHOUT THE WRITTEN PERMISSION OF PEDESTALPRO LLC IS PROHIBITED.				THURSDAY, JULY 3, 2025 1:15:43 PM		SIZE A	PART NO. 104CAB-COME-01-304
				WEIGHT: 58.224		NO SCALE		SHEET 2 OF 10	