

# NOTES:

1. MATERIAL OF CONSTRUCTION IS 304 SS, BRUSHED #4.

<div>www.GooseneckStands.com</div> <div>(888) 378 - 1045</div> <div>Sales@GooseneckStands.com</div>	UNLESS OTHERWISE SPECIFIED:		NAME	DATE	TITLE:				
	DIMENSIONS ARE IN INCHES TOLERANCES: FRACTIONAL ±1/32 ANGULAR: ±2° TWO PLACE DECIMAL ±0.010 THREE PLACE DECIMAL ±0.005	DRAWN	PE		INSTALLATION				
		CHECKED							
		PROPRIETARY AND CONFIDENTIAL THE INFORMATION CONTAINED IN THIS DRAWING IS THE SOLE PROPERTY OF PEDESTALPRO LLC. ANY REPRODUCTION IN PART OR AS A WHOLE WITHOUT THE WRITTEN PERMISSION OF PEDESTALPRO LLC IS PROHIBITED.				MONDAY, JUNE 2, 2025 4:06:35 PM		SIZE A	PART NO. 104CAB-BAIP-01-304
	INTERPRET GEOMETRIC TOLERANCING PER: ASME Y14.5 -2009					WEIGHT: 58.288		NO SCALE	

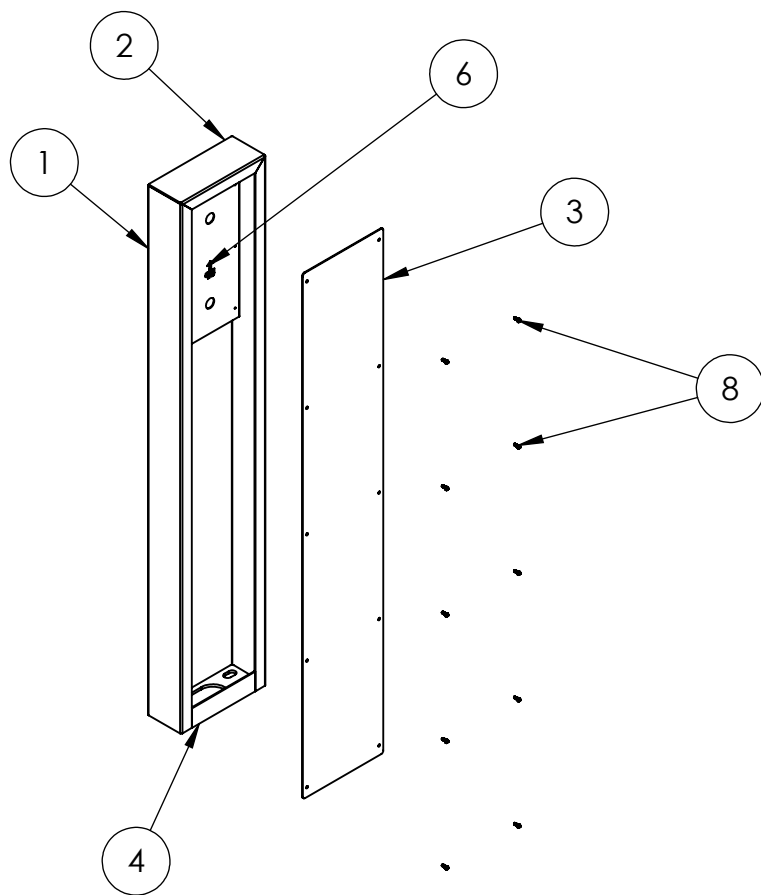

ITEM NO.	PART NUMBER	DESCRIPTION	QTY.
1	104CAB-BAIP-01-304 MAIN BODY	MAIN BODY	1
2	104CAB-BAIP-01-304 TOP	TOP	1
3	104CAB-BAIP-01-304 ACCESS PANEL	ACCESS PANEL	1
4	104CAB-BAIP-01-304 BACK CLOSURE	BACK CLOSURE	1
5	104CAB-BAIP-01-304 BASE PLATE	BASE PLATE	1
6	104CAB-BAIP-01-304 BRACKET	BRACKET	1
7	12GA STIFFENER	STIFFENER	1
8	--	8-32 X 1/2" PAN HEAD SCREW	10

#### NOTES:

- SEE STANDARD PREPARATION AND COATING INSTRUCTIONS FOR COATING PROCEDURE AND COLOR.
- SEE STANDARD PACKAGING INSTRUCTIONS FOR PACKAGING PROCEDURE.

<div>www.GooseneckStands.com</div> <div>(888) 378 - 1045</div> <div>Sales@GooseneckStands.com</div>	UNLESS OTHERWISE SPECIFIED:		NAME	DATE	TITLE:				
	DIMENSIONS ARE IN INCHES TOLERANCES: FRACTIONAL ±1/32 ANGULAR: ±2° TWO PLACE DECIMAL ±0.010 THREE PLACE DECIMAL ±0.005	DRAWN			ASSEMBLY				
		CHECKED							
		PROPRIETARY AND CONFIDENTIAL				MONDAY, JUNE 2, 2025 4:06:35 PM			
	INTERPRET GEOMETRIC TOLERANCING PER: ASME Y14.5 -2009	THE INFORMATION CONTAINED IN THIS DRAWING IS THE SOLE PROPERTY OF PEDESTALPRO LLC. ANY REPRODUCTION IN PART OR AS A WHOLE WITHOUT THE WRITTEN PERMISSION OF PEDESTALPRO LLC IS PROHIBITED.				SIZE <b>A</b>		PART NO. 104CAB-BAIP-01-304	REV <b>A</b>
WEIGHT: 58.288				NO SCALE		SHEET 2 OF 10			