

NOTES:

1. MATERIAL OF CONSTRUCTION IS 304 SS, BRUSHED #4.

<div>www.GooseneckStands.com</div> <div>(888) 378 - 1045</div> <div>Sales@GooseneckStands.com</div>	UNLESS OTHERWISE SPECIFIED:		NAME	DATE	TITLE:			
	DIMENSIONS ARE IN INCHES TOLERANCES: FRACTIONAL ±1/32 ANGULAR: ±2° TWO PLACE DECIMAL ±0.010 THREE PLACE DECIMAL ±0.005	DRAWN	PE		INSTALLATION			
		CHECKED			WEDNESDAY, JUNE 18, 2025 9:21:09 AM			
		PROPRIETARY AND CONFIDENTIAL THE INFORMATION CONTAINED IN THIS DRAWING IS THE SOLE PROPERTY OF PEDESTALPRO LLC. ANY REPRODUCTION IN PART OR AS A WHOLE WITHOUT THE WRITTEN PERMISSION OF PEDESTALPRO LLC IS PROHIBITED.			SIZE A	PART NO. 104CAB-AIPH-03-304	REV A	
	INTERPRET GEOMETRIC TOLERANCING PER: ASME Y14.5 -2009				WEIGHT: 58.314		NO SCALE	

ITEM NO.	PART NUMBER	DESCRIPTION	QTY.
1	104CAB-AIPH-03-304 MAIN BODY	MAIN BODY	1
2	104CAB-AIPH-03-304 TOP	TOP	1
3	104CAB-AIPH-03-304 ACCESS PANEL	ACCESS PANEL	1
4	104CAB-AIPH-03-304 BACK CLOSURE	BACK CLOSURE	1
5	104CAB-AIPH-03-304 BASE PLATE	BASE PLATE	1
6	12GA STIFFENER	STIFFENER	1
7	IX-DVF-4A BOX BRACKET	BRACKET FOR IX-DVF-4A	1
8	--	8-32 X 1/2" PAN HEAD SCREW	10

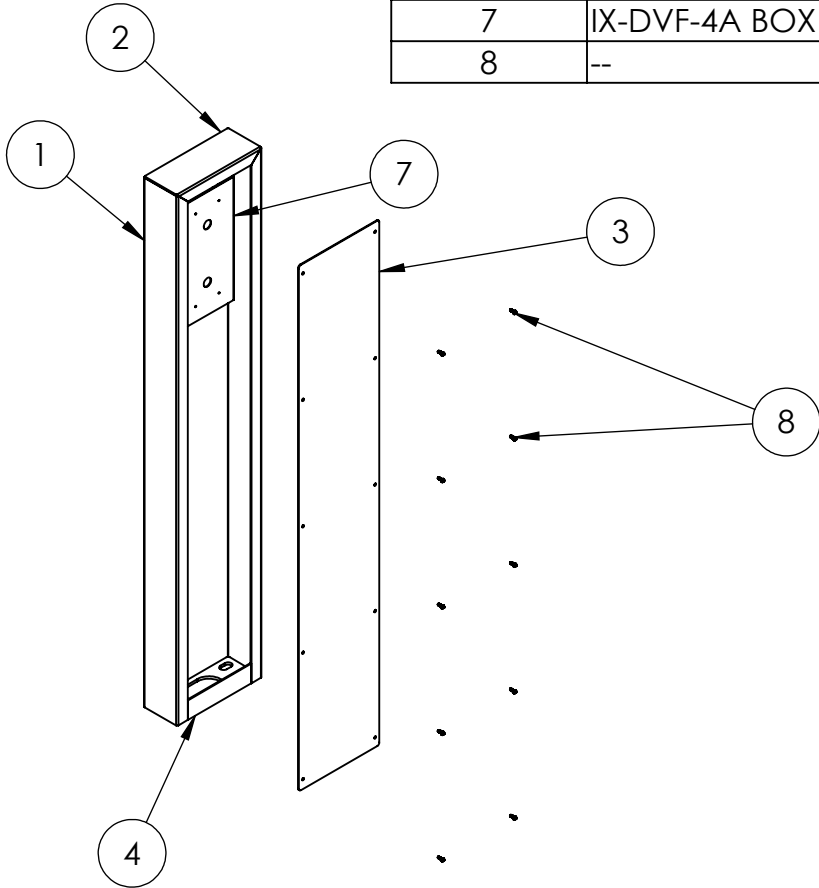

NOTES:

1. SEE STANDARD PREPARATION AND COATING INSTRUCTIONS FOR COATING PROCEDURE AND COLOR.
2. SEE STANDARD PACKAGING INSTRUCTIONS FOR PACKAGING PROCEDURE.

<div>www.GooseneckStands.com</div> <div>(888) 378 - 1045</div> <div>Sales@GooseneckStands.com</div>	UNLESS OTHERWISE SPECIFIED:		NAME		DATE		TITLE:				
	DIMENSIONS ARE IN INCHES TOLERANCES: FRACTIONAL ±1/32 ANGULAR: ±2° TWO PLACE DECIMAL ±0.010 THREE PLACE DECIMAL ±0.005		DRAWN				ASSEMBLY				
			CHECKED								
			PROPRIETARY AND CONFIDENTIAL				WEDNESDAY, JUNE 18, 2025 9:21:09 AM		SIZE A	PART NO. 104CAB-AIPH-03-304	REV A
INTERPRET GEOMETRIC TOLERANCING PER: ASME Y14.5 -2009		THE INFORMATION CONTAINED IN THIS DRAWING IS THE SOLE PROPERTY OF PEDESTALPRO LLC. ANY REPRODUCTION IN PART OR AS A WHOLE WITHOUT THE WRITTEN PERMISSION OF PEDESTALPRO LLC IS PROHIBITED.				WEIGHT: 58.314		NO SCALE		SHEET 2 OF 10	