

- NOTES:
1. MATERIAL OF CONSTRUCTION IS 304 SS, BRUSHED #4.

| | | | | | | | | | | | |
|---|-------------------------------|----------------|--|----------|------|--------------|------------------------|--|------|---------------------|-----|
| <div>www.GooseneckStands.com</div> <div>(888) 378 - 1045</div> <div>Sales@GooseneckStands.com</div> | UNLESS OTHERWISE SPECIFIED: ★ | | NAME | | DATE | | TITLE: | | | | |
| | DIMENSIONS ARE IN INCHES | | DRAWN | | PE | | INSTALLATION | | | | |
| | TOLERANCES: | | CHECKED | | | | | | | | |
| | FRACTIONAL ±1/32 | | PROPRIETARY AND CONFIDENTIAL THE INFORMATION CONTAINED IN THIS DRAWING IS THE SOLE PROPERTY OF PEDESTALPRO LLC. ANY REPRODUCTION IN PART OR AS A WHOLE WITHOUT THE WRITTEN PERMISSION OF PEDESTALPRO LLC IS PROHIBITED. | | | | Thursday, July 3, 2025 | | SIZE | PART NO. | REV |
| | ANGULAR: ±2° | | | | | | 2:11:13 PM | | A | 1018HOU-AIPH-02-304 | C |
| | TWO PLACE DECIMAL ±0.010 | | | | | | | | | | |
| THREE PLACE DECIMAL ±0.005 | | WEIGHT: 19.855 | | NO SCALE | | SHEET 1 OF 7 | | | | | |
| INTERPRET GEOMETRIC TOLERANCING PER: ASME Y14.5 -2009 | | | | | | | | | | | |

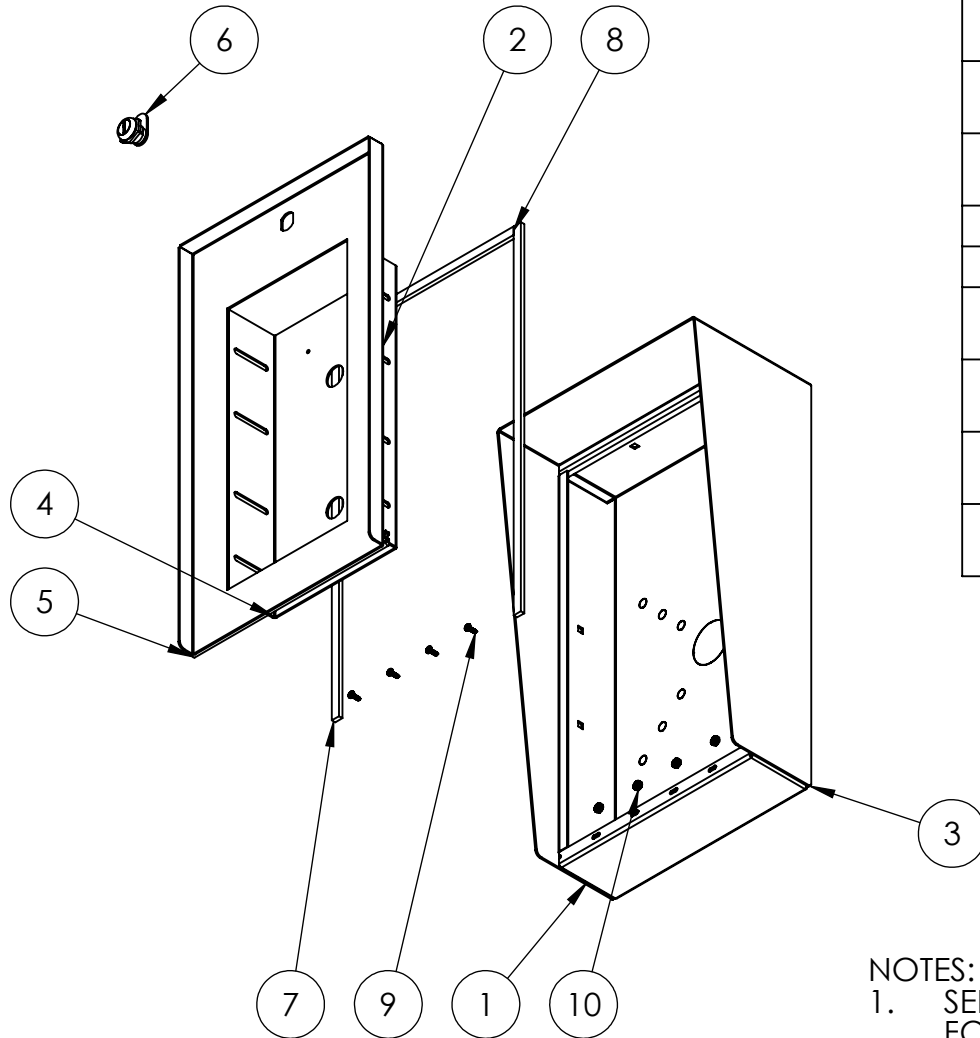

| ITEM NO. | PART NUMBER | DESCRIPTION | QTY. |
|----------|-------------------------------|------------------------------|------|
| 1 | 1018HOU-AIPH-02-304 ENCLOSURE | ENCLOSURE WELDMENT | 1 |
| 2 | 1018HOU-AIPH-02-304 DOOR | DOOR WELDMENT | 1 |
| 3 | 1018HOU-AIPH-02-304 HOOD | HOOD | 1 |
| 4 | IX-DVF-4A BOX BRACKET | BRACKET FOR IX-DVF-4A | 1 |
| 5 | HINGE | PIANO HINGE | 1 |
| 6 | CAM LOCK | STRAIGHT CAM | 1 |
| 7 | GASKET SIDE | 3/8" X .150 WEATHERSTRIPPING | 2 |
| 8 | GASKET TOP | 3/8" X .150 WEATHERSTRIPPING | 1 |
| 9 | -- | 6-32 PAN HEAD SCREW | 4 |
| 10 | -- | 6-32 EXTERNAL TOOTH LOCK NUT | 4 |

NOTES:

- SEE STANDARD PREPARATION AND COATING INSTRUCTIONS FOR COATING PROCEDURE AND COLOR.
- SEE STANDARD PACKAGING INSTRUCTIONS FOR PACKAGING PROCEDURE.

| | | | | | | | | | |
|---|---|--|---|----------------|------------------------|----------|---------------------|--------------|-----|
| <div>www.GooseneckStands.com</div> <div>(888) 378 - 1045</div> <div>Sales@GooseneckStands.com</div> | UNLESS OTHERWISE SPECIFIED: | | NAME | DATE | TITLE: | | | | |
| | DIMENSIONS ARE IN INCHES TOLERANCES: FRACTIONAL ±1/32 ANGULAR: ±2° TWO PLACE DECIMAL ±0.010 THREE PLACE DECIMAL ±0.005 | | DRAWN | | ASSEMBLY | | | | |
| | | | CHECKED | | | | | | |
| | INTERPRET GEOMETRIC TOLERANCING PER: ASME Y14.5 -2009 | | PROPRIETARY AND CONFIDENTIAL | | SIZE | | PART NO. | | REV |
| | | | THE INFORMATION CONTAINED IN THIS DRAWING IS THE SOLE PROPERTY OF PEDESTALPRO LLC. ANY REPRODUCTION IN PART OR AS A WHOLE WITHOUT THE WRITTEN PERMISSION OF PEDESTALPRO LLC IS PROHIBITED. | | Thursday, July 3, 2025 | | 1018HOU-AIPH-02-304 | | C |
| 2:11:13 PM | | | | | | | | | |
| | | | | WEIGHT: 19.855 | | NO SCALE | | SHEET 2 OF 7 | |